

因产品不断研究改良，本公司保留设计参数及配置的变更权，如有变更，恕不另行通告。
所有解释权以中文解释为准，产品照片仅供参考，与出售实物略有不同。

Because of the products' constant research and innovation, our company reserves the right to change the design parameters and configuration; in case of any change, there will be no further notice.
The interpretation in Chinese shall prevail.
The photos of the products are for reference only, which is slightly from the products actually sold.

Zhongshan Yubao Intelligent Equipment Co., Ltd.

中山市煜豹智能设备有限公司

YUBAO SMART
www.zsyubao.com

YUBAO SMART

Zhongshan Yubao Intelligent Equipment Co., Ltd.

Add: No. 31, Bihua Avenue, Baishi Village,
Sanxiang Town, Zhongshan City,
Guangdong Province

Tel: +86 188 2498 9993/ +86 153 2393 1805

Web: www.zsyubao.com

Email: zsyubao@163.com

中山市煜豹智能设备有限公司

地址：广东省中山市三乡镇白石村碧华大道31号

电话：+86 188 2498 9993/ +86 153 2393 1805

网址：www.zsyubao.com

邮箱：zsyubao@163.com

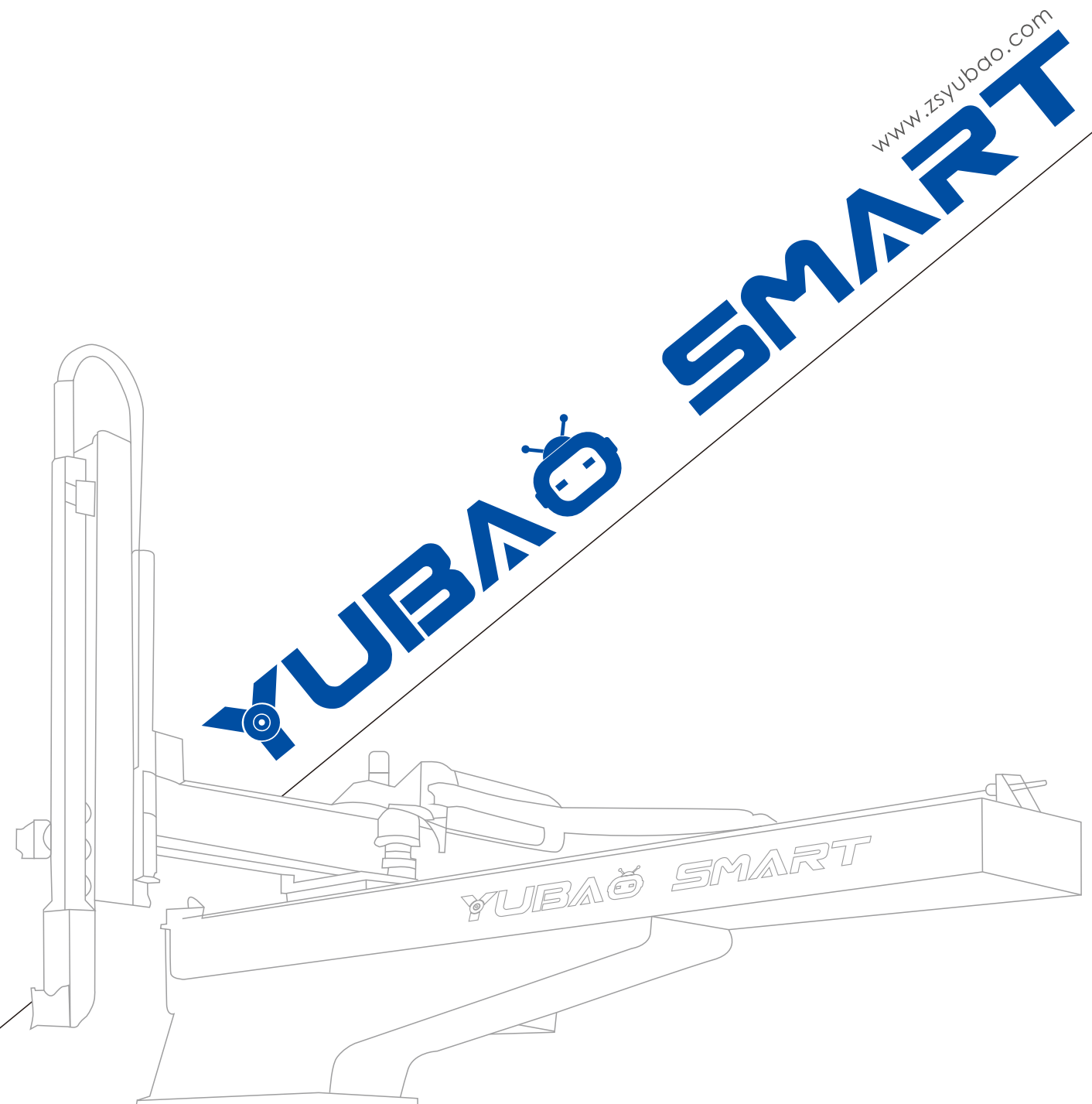



Company Profile

公司简介

中山市煜豹智能设备有限公司成立于2016年3月，在企业成长过程中，煜豹由注塑机专用机械手奠定根基为契机，进而拓展到工业机器人、智能工业机械臂、非标自动化、智能康复训练设备、集成自动化生产线整合研发与应用；提供一站式智造解决方案。煜豹设立在广东省中山市三乡镇，以粤港澳大湾区为核心，业务范围覆盖全广东省，不断研究创新，以高度成熟的技术、丰富的经验、完善的服务、合理的价格提供客户优质的产品 & 整体解决方案，获得一致的好评与肯定。

经过多年的积累沉淀，公司培育了一支高素质、重实战的研发团队。除标准机型设计外，另成立非标自动化应用部门，为用户更大程度的提供自动化解决方案。运用先进的计算机辅助设计系统，通过3D立体设计，真实情况模拟与分析，实现系统整合，机械设计、电路设计、软件开发、治具开发等研发工作。

Zhongshan Yubao Intelligent Equipment Co., Ltd. was established in March 2016. During the growth of the company, Yubao took the opportunity to lay the foundation for the special manipulator for injection molding machines, and then expanded to industrial robots, intelligent industrial manipulators, non-standard automation, and intelligent rehabilitation. Training equipment and integrated automated production line integrate R&D and application; provide one-stop intelligent manufacturing solutions. Yubao is established in Sanxiang Town, Zhongshan City, Guangdong Province, with the Guangdong-Hong Kong-Macao Greater Bay Area as its core. Its business scope covers the entire Guangdong Province. It continuously researches and innovates, and provides customers with highly mature technology, rich experience, comprehensive services and reasonable prices. High-quality products and overall solutions have won unanimous praise and affirmation.

After many years of accumulated experience, our company has cultivated a high-quality and rich specific experienced R&D team. We not only design standard mold of robot, but also research non-standard automatic design. It greatly helps users to get automatic solutions.

Using advanced computer-aided design system and 3D design, simulates and analyzes real solution to achieve integration of multiple stations, mechanical design, circuit design, researched parts development, jig development etc.

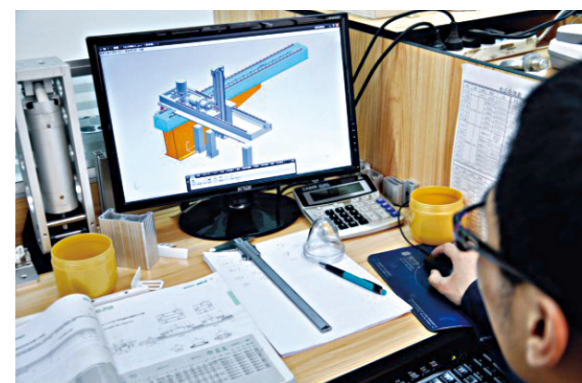

证书

Certificate



▶ 商标与高新产品/Trademarks and high-tech products



▶ 专利证书/Patent certificate



车间展示

Workshop

公司致力于机械手的性能研究，致力于自动化在行业的应用，力争成为自动化领域的一流企业，为社会创造价值，节省能源，并以此改善人们的生活品质。

The company is committed to the performance research of manipulators, is committed to the application of automation in the industry, and strives to become a first-class enterprise in the field of automation, creating value for society, saving energy, and improving people's quality of life.

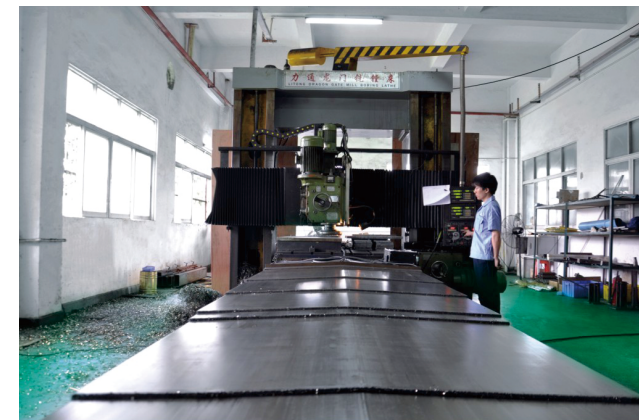

智能型三轴伺服机械手

Intelligent three-axis servo manipulator

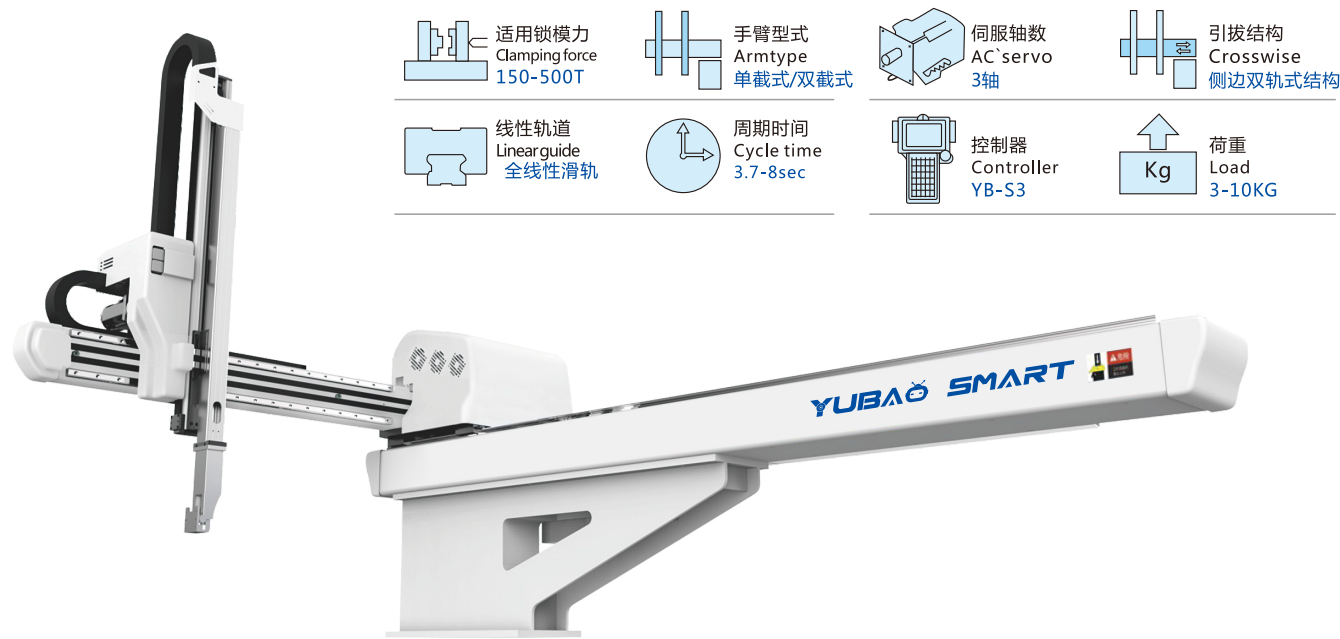

- 适用锁模力 Clamping force 150-500T
- 手臂型式 Armtype 单截式/双截式
- 伺服轴数 AC servo 3轴
- 引拔结构 Crosswise 侧边双轨式结构
- 线性轨道 Linearguide 全线性滑轨
- 周期时间 Cycle time 3.7-8sec
- 控制器 Controller YB-S3
- 荷重 Load 3-10KG

智能型五轴伺服机械手

Intelligent five-axis servo manipulator

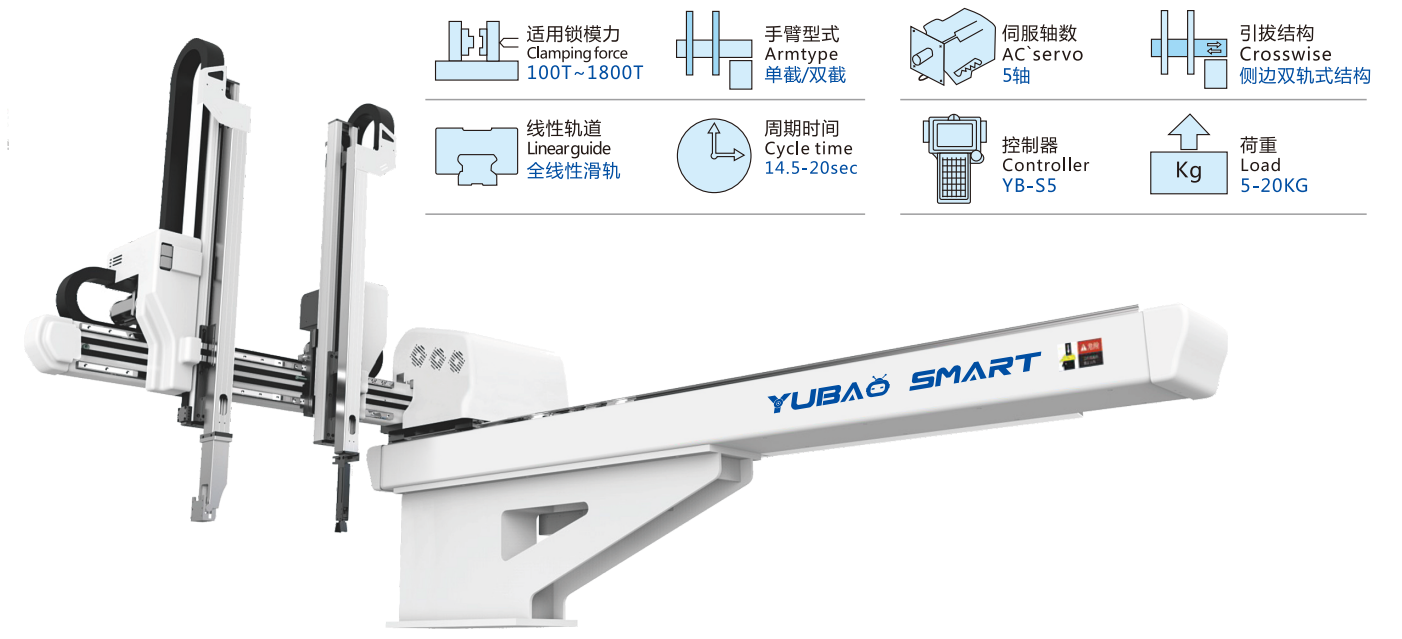

- 适用锁模力 Clamping force 100T~1800T
- 手臂型式 Armtype 单截/双截
- 伺服轴数 AC servo 5轴
- 引拔结构 Crosswise 侧边双轨式结构
- 线性轨道 Linearguide 全线性滑轨
- 周期时间 Cycle time 14.5-20sec
- 控制器 Controller YB-S5
- 荷重 Load 5-20KG

基本参数/Common Specifications

机型 Model	电源容量 (kva) Power capacity	适用成型机 (ton) Recom. mtd LMMM	横行行程 (mm) Traversa stroke	驱动方式 Traversa Driven	引拔行程 (mm) Crosswise stroke	上下行程 (mm) Vertical stroke	最大荷重 (kg) Max. loading	取出时间 (sec) Dry take out time	全循环时间 (sec) Dry cycle time	空气消耗量 (Ni/cycle) Air consumption	净重(kg) Net weight
YBB08 ISS3	2.1	150T-250T	1600	AC 伺服马达 AC servo motor	550	800	5	2.5	7.1	6.0	340
YBB10 ISS3		250T-380T				1000		2.75	7.9	8.0	390
YBB08 WSS3		120T-250T	1400		480	800	0.75	3.7	2.8	250	
YBB10 WSS3		250T-380T	1600		550	1000	0.9	4.4	3.5	300	
YBB12 WSS3	2.5	350T-500T	1800		800	1200	10	1.04	4.8	6.8	550

机型表示 : I : 单截式 W : 双截式 S : 单臂 (成品臂) S3 : 三轴AC伺服马达驱动 (成品臂上下、引拔+横行) S5 : 五轴AC伺服马达驱动 (双臂上下、引拔+横行)
 Denoted: I: Single cut W: Double-cut type S: Single arm (finished arm) S3: Three-axis AC servo motor drive (Arms up and down, drawing + horizontal movement)
 S5: Five-axis AC servo motor drive (finished arm up and down, drawing + horizontal movement)

外形尺寸/Outer Dimensions

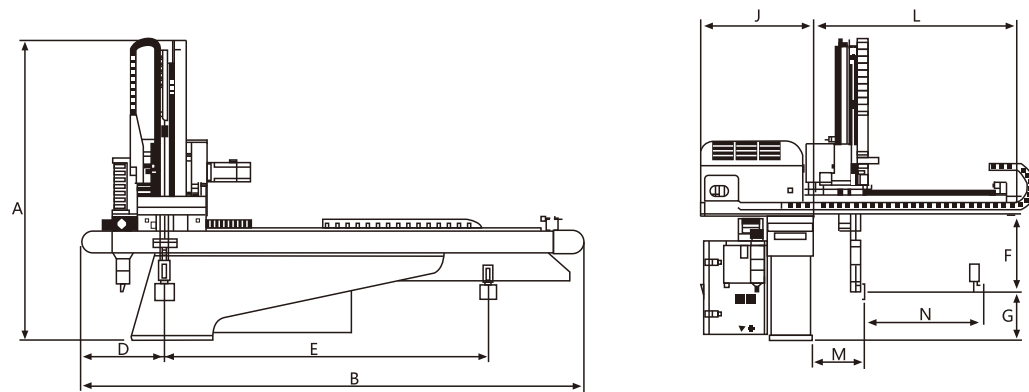

机型 Model	A	B	C	D	E	F	G	H	I	J	K	L	M	N
YBB08ISS3	1850	2510	800	440	1600	355	190	/	/	500	/	1200	200	760
YBB10ISS3	2000	2510	1000	440	1600	360	190	/	/	500	/	1200	200	760
YBB08WSS3	1350	2180	800	370	1400	435	105	/	/	455	/	840	315	400
YBB10WSS3	1450	2380	1000	370	1400	435	105	/	/	455	/	960	300	550
YBB12WSS3	1580	2480	1200	325	1800	400	195	/	/	515	/	1185	250	800

基本参数/Common Specifications

机型 Model	电源容量 (kva) Power capacity	适用成型机 (ton) Recom. mtd LMMM	横行行程 (mm) Traversa stroke	驱动方式 Traversa Driven	引拔行程 (mm) Crosswise stroke	上下行程 (mm) Vertical stroke	最大荷重 (kg) Max. loading	取出时间 (sec) Dry take out time	全循环时间 (sec) Dry cycle time	空气消耗量 (Ni/cycle) Air consumption	净重(kg) Net weight
YBB08 IDS5	3.2	100T-250T	1400	AC 伺服马达 AC servo motor	P:550 R:400	800	5	2.18	6.78	3.5	240
YBB08 WDS5		120T-220T			P:480 R:480			2.67	6.85	4	300/260
YBB10 WDS5	3.9/2.4	220T-400T	1600		P:550 R:550	1000	8	2.83	9.55	6	360/310
YBB12 WDS5		400T-600T	1800		P:800 R:800	1200	10	3.1	11.75	6.8	530/470
YBB15 WDS5	5/3.1	600T-800T	2200	P:1000 R:800	1500	15	2.3	15	15	730/650	
YBB18 WDS5	5.1/3.1	800T-1200T	2500				1800	20	2.8	20	20

机型表示 : I : 单截式 W : 双截式 D : 成品臂+料头臂 S : 单臂 (成品臂) S3 : 三轴AC伺服马达驱动 (成品臂上下、引拔+横行) S5 : 五轴AC伺服马达驱动 (双臂上下、引拔+横行)
 Denoted: I: Single section type W: Double section type D: Finished arm + material end arm S: Single arm (finished arm) S3: Three-axis AC servo motor drive (finished arm up and down, drawing + horizontal movement) S5: Five-axis AC servo Motor drive (both arms up and down, drawing + horizontal movement)

外形尺寸/Outer Dimensions

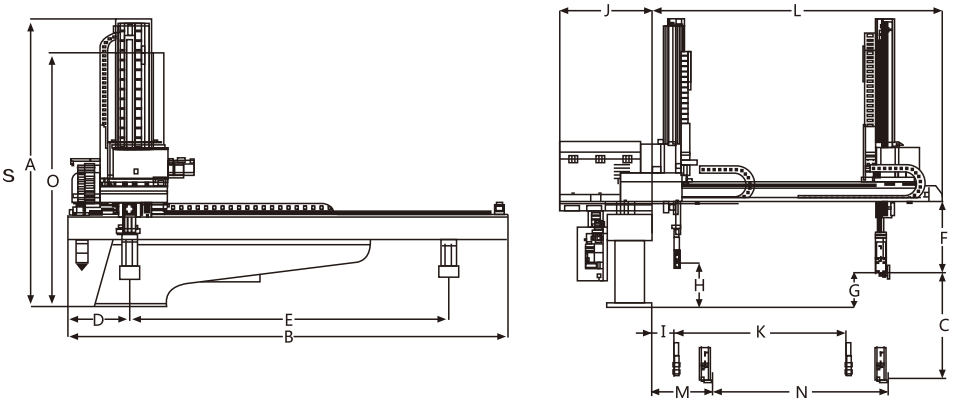

机型 Model	A	B	C	D	E	F	G	H	I	J	K	L	M	N
YBB08IDS5	1685	2220	800	370	1400	340	185	200	155	425	400	1050	315	500
YBB08WDS5	1350	2220	800	385	1400	380	155	190	130	505	420	1096	420	/
YBB10WDS5	1510	2510	1000	440	1600	400	155	210	155	495	500	1205	500	/
YBB12WDS5	1660	2480	1200	380	1800	400	180	230	125	512	700	1642	700	/
YBB15WDS5	2000	2980	1500	370	2200	500	305	380/50	200	543	800	1845	1000	1590
YBB18WDS5	2100	3810	1800	950	2500	580	200	260/50	200	530	800	1840	1000	1600

单轴伺服横走式机械手

Single Axis Servo Driven Beam Robots

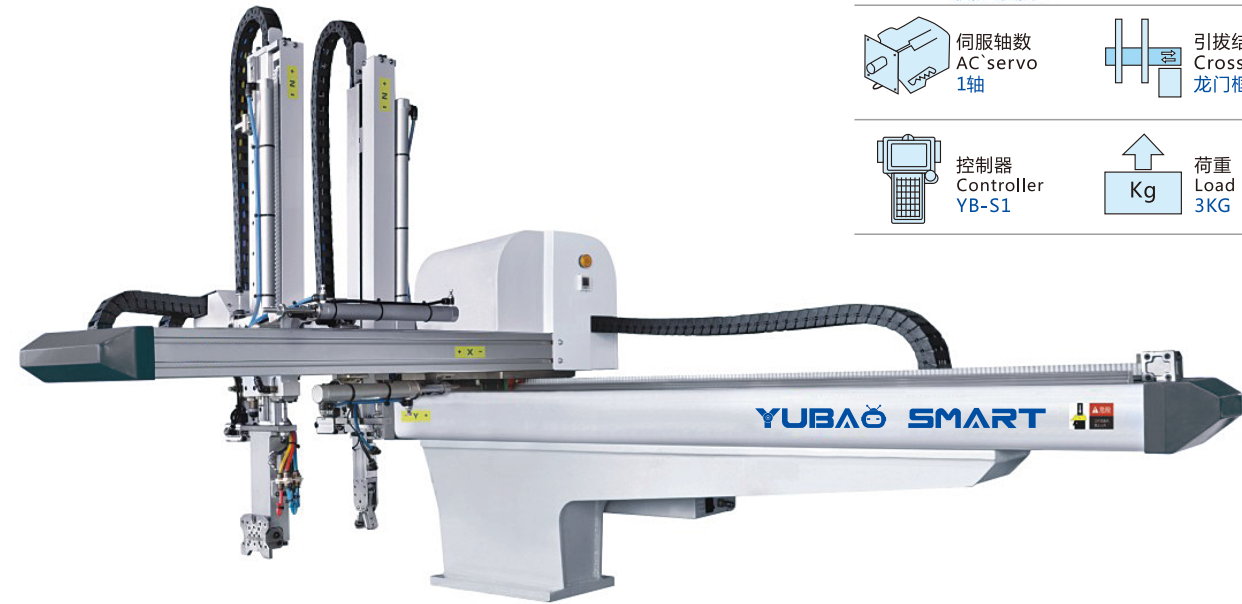

- 适用锁模力
Clamping force
50T~350T
- 手臂型式
Arm type
单截/双截
- 线性轨道
Linear guide
上下线性滑轨
引拔线性导杆
横行线性滑轨
- 周期时间
Cycle time
8-10sec
- 伺服轴数
AC servo
1轴
- 引拔结构
Crosswise
龙门框架式结构
- 控制器
Controller
YB-S1
- 荷重
Load
3KG

基本参数/Common Specifications

电源 Power source	工作气压 Working pressure	最大容许气压 Max, allowed pressure	驱动方式 Driven system	侧姿 Swivel	控制系统 Control system
AC220V±10V 50/60HZ	5kgf/cm ² 0.49Mpa	8kgf/cm ² 0.8Mpa	Y AC servo motor X,Z pneumatic cylinder	90°Fixed Pnumatic	YB-S1

综合参数/General Specifications

机型 Model	电源容量 (kva) Power capacity	适用成型机 (ton) Recom. mended LMMM	横行行程 (mm) Traversa stroke	横行驱动方式 Traversa driven	引拔行程 (mm) Crosswise stroke	上下行程 (mm) Vertical stroke	最大荷重 (kg) Max. loading	取出时间 (sec) Dry take out time	全循环时间 (sec) Dry cycle time	空气消耗量 (Ni/cycle) Air consumption	净重(kg) Net weight
YBA07 WD/WS	0.6	50-220	1300	AC伺服 马达驱动	P:200R:200	700	3	1.3	8.1	3.5	150-195
YBA09 WD/WS		200-350	1300		P:200R:200	900		1.4	9	4.2	160-230

机型表示: W: 双截式 S: 单臂(成品臂) D: 成品臂+料头臂 S1: 横行AC伺服马达驱动
Model denoted: W: Double-cut type S: Single arm (finished arm) D: Finished arm + material end arm S1: Driven by AC servo motor

外形尺寸/Outer Dimensions

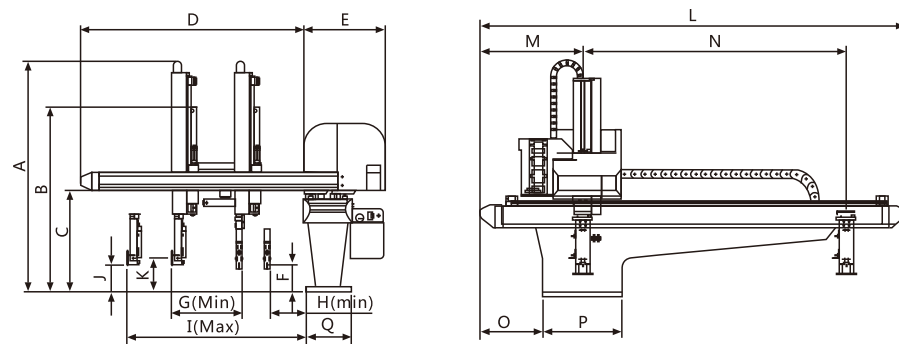

机型Model	A	B	C	D	E	F	G	H	I	J	K	L	M	N	O	P	Q
YBA07WD/WS	1070	880	430	880	360	160	130	130	600	125	150	1950	290	1300	130	350	200
YBA09WD/WS	1180	1000		1000					800								

单轴伺服横走式机械手

Single Axis Servo Driven Beam Robots

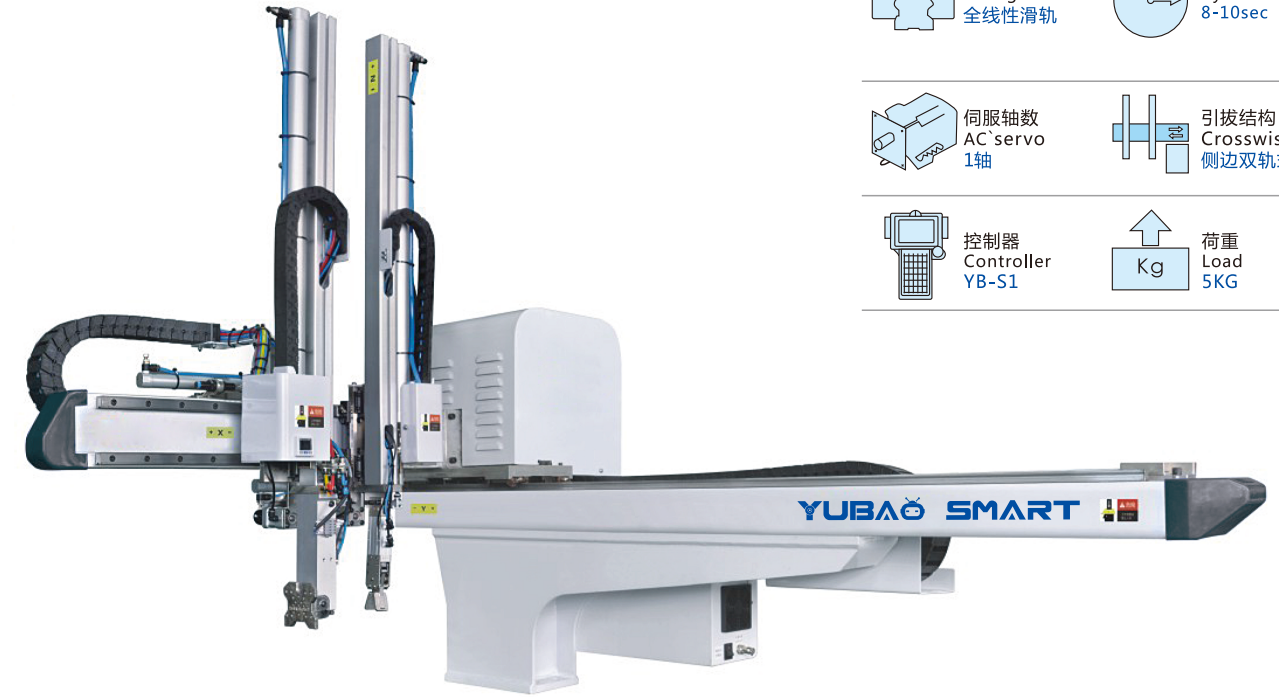

- 适用锁模力
Clamping force
50T~350T
- 手臂型式
Arm type
单截/双截
- 线性轨道
Linear guide
全线性滑轨
- 周期时间
Cycle time
8-10sec
- 伺服轴数
AC servo
1轴
- 引拔结构
Crosswise
侧边双轨式结构
- 控制器
Controller
YB-S1
- 荷重
Load
5KG

基本参数/Common Specifications

电源 Power source	工作气压 Working pressure	最大容许气压 Max, allowed pressure	驱动方式 Driven system	侧姿 Swivel	控制系统 Control system
AC220V±10V 50/60HZ	5kgf/cm ² 0.49Mpa	8kgf/cm ² 0.8Mpa	Y AC servo motor X,Z pneumatic cylinder	90°Fixed Pnumatic	YB-S1

综合参数/General Specifications

机型 Model	电源容量 (kva) Power capacity	适用成型机 (ton) Recom. mended LMMM	横行行程 (mm) Traversa stroke	横行驱动方式 Traversa driven	引拔行程 (mm) Crosswise stroke	上下行程 (mm) Vertical stroke	最大荷重 (kg) Max. loading	取出时间 (sec) Dry take out time	全循环时间 (sec) Dry cycle time	空气消耗量 (Ni/cycle) Air consumption	净重(kg) Net weight
YBB07I/W	0.6	50-220	1300	AC伺服 马达驱动	P:200R:200	700	5	2.2	8.1	5.5	185-235
YBB08I/W		180-250	1300		P:200R:200	800		2.3	8.5	6.2	210-250
YBB09I/W		180-350	1300 (1540)		P:200R:200	900		2.4	9	6.8	220-260

机型表示: I: 单截式 W: 双截式 S: 单臂(成品臂) D: 成品臂+料头臂 S1: 横行AC伺服马达驱动
Model denoted: I: Single section type W: Double section type S: Single arm (finished arm) D: Finished arm + material end arm S1: Driven by AC servo motor

外形尺寸/Outer Dimensions

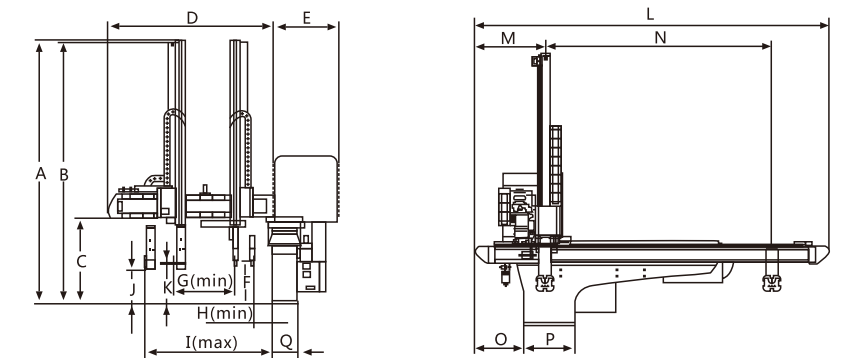

机型Model	A	B	C	D	E	F	G	H	I	J	K	L	M	N	O	P	Q
YBB07I/W	1370 1010	1350 930	450	880	360	215 200	135 160	70 150	680	180	217 200	1950 2200	610	1300	485	250	138
YBB08I/W	1470 1100	1450 1000	450	1000		215 230			840	180 200	217 225						
YBB09I/W	1570 1160	1550 1060	475	1000		435			350	180							

单轴伺服横走式机械手

Single Axis Servo Driven Beam Robots

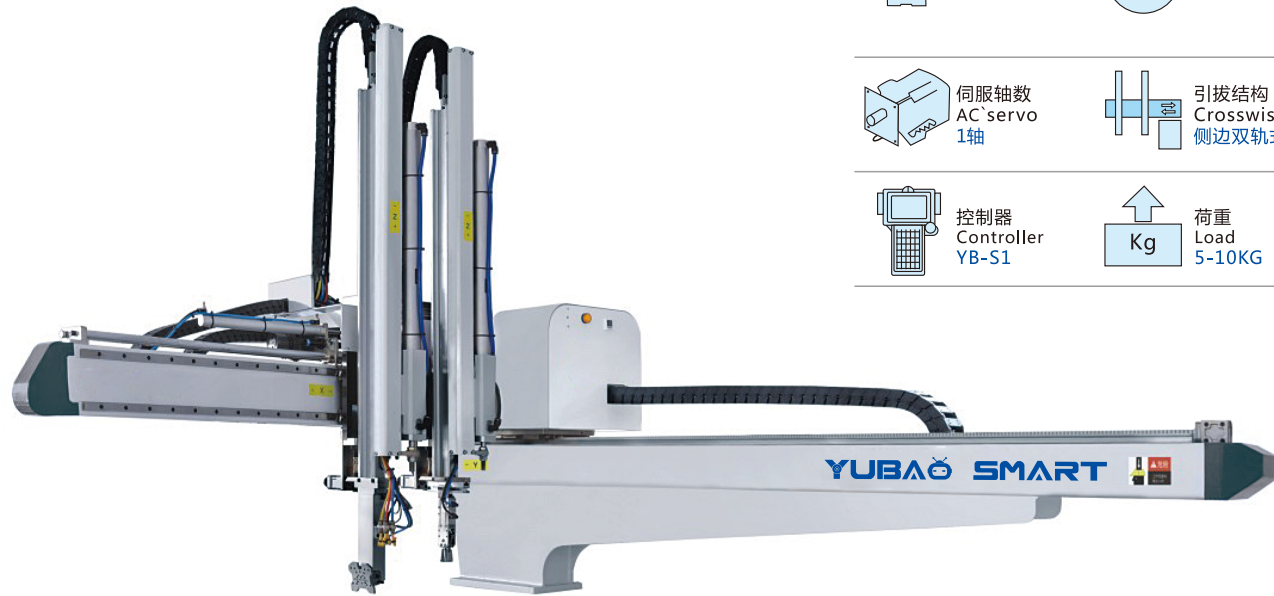

- 适用锁模力 Clamping force 350T~650T
- 手臂型式 Arm type 单载/双载
- 线性轨道 Linear guide 全线性滑轨
- 周期时间 Cycle time 14.5-20sec
- 伺服轴数 AC servo 1轴
- 引拔结构 Crosswise 侧边双轨式结构
- 控制器 Controller YB-S1
- 荷重 Load 5-10KG

基本参数/Common Specifications

电源 Power source	工作气压 Working pressure	最大容许气压 Max, allowed pressure	驱动方式 Driven system	侧姿 Swivel	控制系统 Control system
AC220V±10V 50/60HZ	5kgf/cm ² 0.49Mpa	8kgf/cm ² 0.8Mpa	Y AC servo motor X,Z pneumatic cylinder	90°Fixed Pnumatic	YB-S1

综合参数/General Specifications

机型 Model	电源容量 (kva) Power capacity	适用成型机 (ton) Recom. mended LMMM	横行程 (mm) Traversa stroke	横行驱动方式 Traversa driven	引拔行程 (mm) Crosswise stroke	上下行程 (mm) Vertical stroke	最大荷重 (kg) Max. loading	取出时间 (sec) Dry take out time	全循环时间 (sec) Dry cycle time	空气消耗量 (Ni/cycle) Air consumption	净重(kg) Net weight									
YBB11 WD/WS	1	350-550	1540(1800)	Y: AC 伺服马达驱动	P:300R:150	1100	5-10	2.8	14.5	40	355-380									
YBB13 WD/WS												400-600	1800(2200)	P:400R:200	1300	3	20	80	480-550	
YBB07 ID/IS																				50-220
YBB08 ID/IS	100-250	1300(1540)	300	800	5	0.8	8	8	210-250											
YBB09 ID/IS	200-350	200-350	300	900	5	1.0	8.2	10	220-260											
YBB11 WD/WS	3	400-600	1540(1800)	Y: AC 伺服马达驱动	P:300R:150	1100	5-10	2.8	14.5	40	355-380									
YBB13 WD/WS												650-1000	2000(2200)	400	1300	11	1.5	10	70	480-550
YBB15 WD/WS																				
YBB17 WD/WS												850-1300	2700(3000)	1300	1700	20	2.0	14	90	1350-1600

机型表示: W: 双截式 S: 成品臂 D: 成品臂+料头臂 A: 引拔电动调位 G: 上下电动调位 S1: 横行AC伺服马达驱动
Model denoted: W: Telescopic type S: Product arm D: Product arm+Runner arm A: Remote adjustment of crosswise axis
G: Remote adjustment of vertical axis S1: AC servo driven on traversa axis

外形尺寸/Outer Dimensions

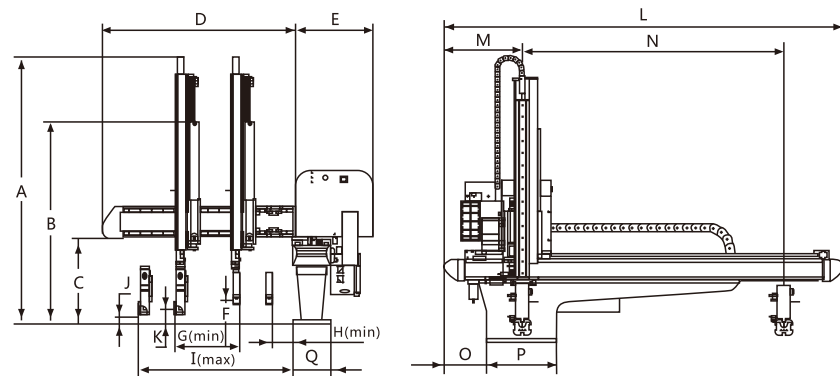

机型 Model	A	B	C	D	E	F	G	H	I	J	K	L	M	N	O	P	Q
YBB11WD/WS	1570	1240	625	1030	530	280	135	130	890	200	230	1950	285	1300	55	450	250
YBB13WD/WS	1600	1250		1290	530	280	135	130	1000			2000					

二轴伺服横走式机械手

Two Axis Servo Driven Beam Robots

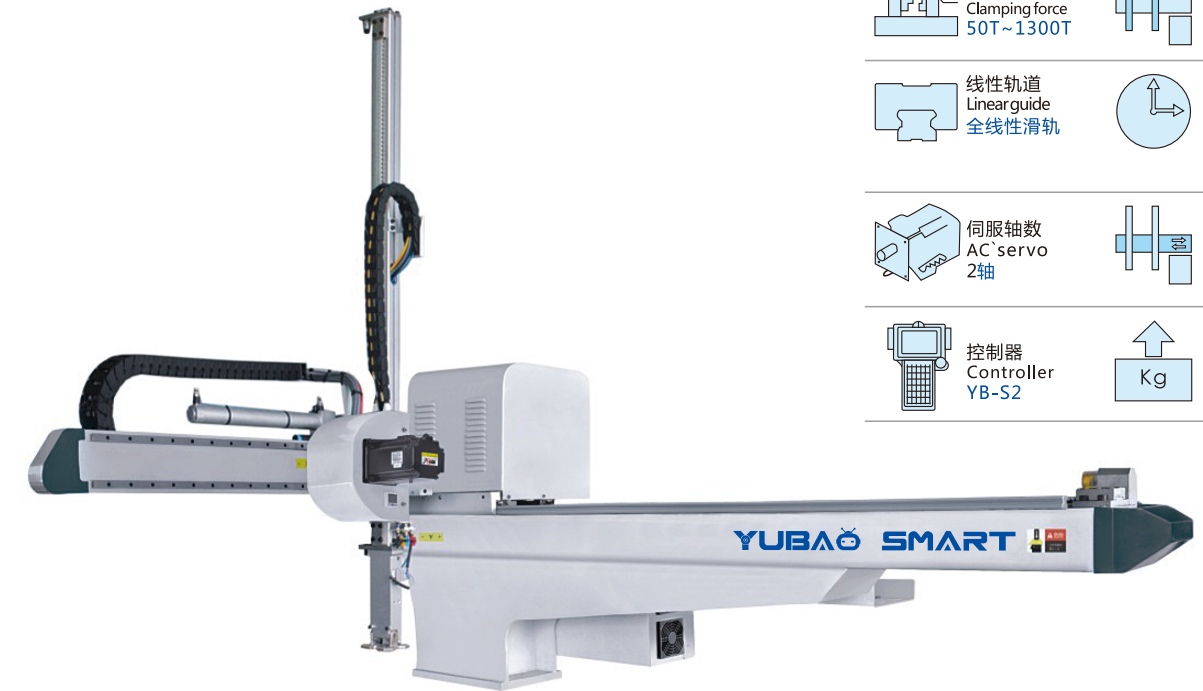

- 适用锁模力 Clamping force 50T~1300T
- 手臂型式 Arm type 单载/双载
- 线性轨道 Linear guide 全线性滑轨
- 周期时间 Cycle time 7.5-14sec
- 伺服轴数 AC servo 2轴
- 引拔结构 Crosswise 侧边双轨式结构
- 控制器 Controller YB-S2
- 荷重 Load 5-20KG

综合参数/General Specifications

机型 Model	电源容量 (kva) Power capacity	适用成型机 (ton) Recom. mended LMMM	横行程 (mm) Traversa stroke	引拔行程 (mm) Crosswise stroke	上下行程 (mm) Vertical stroke	最大荷重 (kg) Max. loading	取出时间 (sec) Dry take out time	全循环时间 (sec) Dry cycle time	空气消耗量 (Ni/cycle) Air consumption	净重(kg) Net weight	
YBB07 ID/IS	2.5	50-220	1100	300	700	5	0.8	7.5	8	185-235	
YBB08 ID/IS					800			8			210-250
YBB09 ID/IS					900			8.2			220-260
YBB11 WD/WS	3	400-600	1540(1800)	400	1100	10	1.2	8.7	70	355-380	
YBB13 WD/WS					1300			10			480-550
YBB15 WD/WS					1500			12			520-585
YBB17 WD/WS					1700			14			1350-1600

机型表示: I: 单截式 W: 双截式 S: 成品臂 D: 成品臂+料头臂 S2: 二轴伺服马达驱动 A: 引拔电动调位 G: 上下电动调位
Model denoted: I: Single stage W: Telescopic type S: Product arm D: Product arm+Runner arm S2: AC servo motor driven on 2 axis
A: Remote adjustment of crosswise axis G: Remote adjustment of vertical axis

外形尺寸/Outer Dimensions

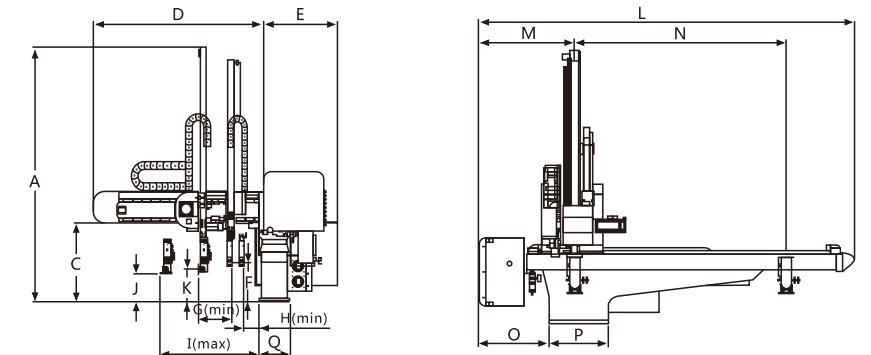

机型 Model	A	C	D	E	F	G	H	I	J	K	L	M	N	O	P	Q
YBB07ID/IS	1520	460	860	485	215	135	120	580	180	205	2100	365	1100	415	350	200
YBB08ID/IS	1620		860					800			2300		1300			
YBB09ID/IS	1720		860					800			2500		1540			
YBB11WD/WS	1440		860					980			2500		1540			
YBB13WD/WS	1650	600	1290	530	225	200	100	1250	160	215	2600	400	2000	420	450	250
YBB15WD/WS	1890	700	1500		230		150	180	3000	400	186	3000	400	2400	420	600
YBB17WD/WS	2200	790	1680	545	250	150	180	1560	180	160	3700	520	2700	450	700	410

纵走式三轴 / 五轴伺服机械手

Vertical-travel three-axis / five-axis servo manipulator

- 适用锁模力 Clamping force 100T~1300T
- 手臂型式 Armtype 双截式
- 线性轨道 Linearguide 全线性滑轨
- 周期时间 Cycle time 1.5-6.05sec
- 伺服轴数 AC servo 1/5轴
- 引拔结构 Crosswise 侧边双轨式结构
- 控制器 Controller YB-S3/S5
- 荷重 Load 5-15KG



基本参数/Common Specifications

机型 Model	电源容量 (kva) Power capacity	适用成型机 (ton) Recommended LMMM	横行行程 (mm) Traversa stroke	驱动方式 Traversa Driven	引拔行程 (mm) Crosswise stroke	上下行程 (mm) Vertical stroke	最大荷重 (kg) Max. loading	取出时间 (sec) Dry take out time	全循环时间 (sec) Dry cycle time	空气消耗量 (Ni/cycle) Air consumption	净重(kg) Net weight
YBTV08IDS5	/	100T-250T	横行拱总长 6米以内 Total length of horizontal arch Within 6 meters	AC 伺服马达 AC servo motor	待定 To be determined	800	5	1.5	待定 To be determined	10	570
YBTV10WDS5	/	200T-400T				1000	5	2		10	660
YBTV12WDS5	/	380T-650T	1200			10	2.68	10		610	
YBTV15WSS3	/	650T-1000T	920(参考注塑机:海天1000T)			1500	15	6.25		10	/
YBTV18WSS3	/	800T-1300T	850(参考注塑机:震雄1000T)			1800	15	6.05		10	/

机型表示: W: 双截式 I: 单截式 D: 双臂机械手(成品臂+料斗臂) S5: 五轴AC伺服马达驱动(成品臂上下、引拔+横行) 待定:根据注塑机吨位大小来确定参数
 Denoted: W: Double section type I: Single section type D: Double-arm manipulator (finished arm + hopper arm) S5: Five-axis AC servo motor drive (finished arm up and down, drawing + horizontal movement) To be determined: the parameters are determined according to the tonnage of the injection molding machine

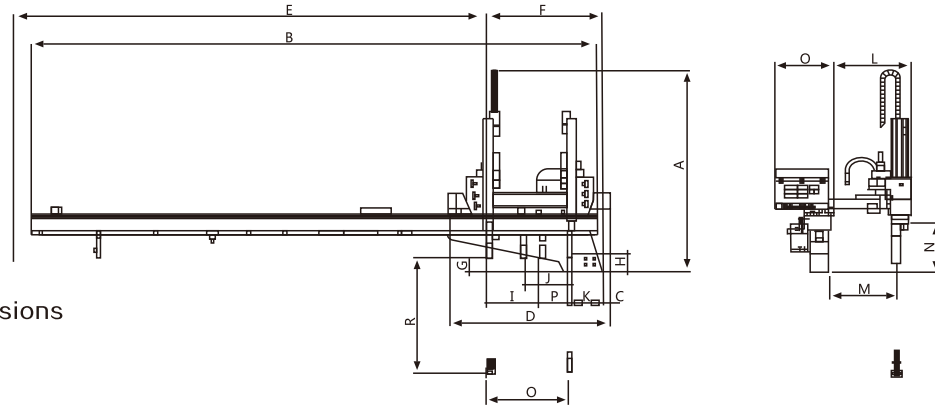

外形尺寸/Outer Dimensions

机型 Model	A	B	C	D	E	F	G	H	I	J	K	L	M	N	O	P	Q	R
YBTV08IDS5	1650	横行拱总长 6米以内	70	1400	3000-5000	1120	140	170	740	700	215	660	待定 To be determined	370	500	170	500	800
YBTV10WDS5	1700			1400		1000	120	160	540	500	270	670		430	500		500	1000
YBTV12WDS5	1900			1520		1130	100	150	650	600	280	700		480	515		515	1200
YBTV15WSS3	1900	横行拱总长 8米以内		/		/	/	/	/	/	/	/		/	/		/	/
YBTV18WSS3	2300			/		/	/	/	/	/	/	/		/	/		/	/

重型三轴 / 五轴伺服机械手

Heavy-duty three-axis / five-axis servo manipulator

- 适用锁模力 Clamping force 220T~3200T
- 手臂型式 Armtype 双截式/单截式
- 线性轨道 Linearguide 全线性滑轨
- 周期时间 Cycle time 15.92-39.84sec
- 伺服轴数 AC servo 1/5轴
- 引拔结构 Crosswise 牛头式牵引结构
- 控制器 Controller YB-S5/S3
- 荷重 Load 10-50KG



基本参数/Common Specifications

机型 Model	电源容量 (kva) Power capacity	适用成型机 (ton) Recommended LMMM	横行行程 (mm) Traversa stroke	驱动方式 Traversa Driven	引拔行程 (mm) Crosswise stroke	上下行程 (mm) Vertical stroke	最大荷重 (kg) Max. loading	取出时间 (sec) Dry take out time	全循环时间 (sec) Dry cycle time	空气消耗量 (Ni/cycle) Air consumption	净重(kg) Net weight
YBT10WSS3	3.1	220T-350T	1600	AC 伺服马达 AC Servo motor	660	1000	10	3.01	15.92	6	450
YBT12WSS3	3.1	350T-500T	1800		900	1200	10	3.2	16.32	6.8	510
YBT15WSS3/S5	3.2/4.2	650T-800T	2200		1070	1500	15	5.1	15.92	10	805
YBT18WSS3/S5	4.3/5.4	800T-1300T	2500		1520	1800	20	5.3	16.32	18	1430
YBT22WSS3/S5	4.3/6.2	1300-1800T	3000		1800	2200	30	6.0	17.89	25	1600
YBT26WSS3/S5	5.5/7.4	1800-2400T	3500		2200	2600	40	8.0	29.23	34	2200
YBT30WSS3/S5	5.5/7.4	2400T-3200T	4000		2500	3000	50	10.0	39.84	47	2450

机型表示: W: 双截式 S: 单臂机械手(成品臂) S3: 三轴AC伺服马达驱动(成品臂上下、引拔+横行) 选型: S5: 五轴AC伺服马达驱动(成品臂上下、引拔+横行)
 Model denoted: W: Telescopic type S: Prductarm S3: Three-axis by AC Servo Molor (Traversa-axis+Crosswise-axis) S5: Five-axis by AC Servo Molor (Traversa-axis+Crosswise-axis)

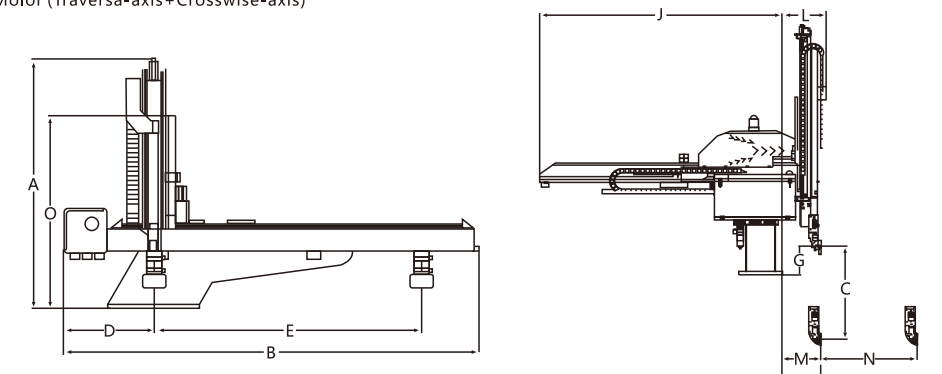

外形尺寸/Outer Dimensions

机型 Model	A	B	C	D	E	F	G	H	I	J	K	L	M	N	O
YBT10WSS3	1520	2510	1000	540	1600	/	235	/	/	820	/	340	320	660	/
YBT12WSS3	1650	270	1200		1800	/	235	/	/	1010	/	310	290	900	1270
YBT15WSS3/S5	1910	3400	1500	580	2200	/	180	/	1640	/	/	465	450	1070	/
YBT18WSS3/S5	2330	3585	1800		2500	/	105	/	2258	/	/	415	362	1520	1640
YBT22WSS3/S5	2530	4125	2200		3000	/	110	/	2416	/	/	515	462	1800	1840
YBT26WSS3/S5	2730	4650	2600		3500	/	80	/	2832	/	/	540	550	2200	2040
YBT30WSS3/S5	2930	5125	3000		4000	/		/	3132	/	/			2500	2240

立式注塑机专用机械手

Picker For Vertical Molding Machine

- 适用锁模力
Clamping force
150T以下
- 手臂型式
Armtype
单截式
- 线性轨道
Linearguide
上下线性滑轨
引拔线性导杆
- 周期时间
Cycle time
4.4sec
- 控制器
Controller
YB-X1
- 荷重
Load
2KG



基本参数/Common Specifications

电源 Power source	电源容量 (KVA) Power source	工作气压 Working pressure	最大容许气压 Max, allowed pressure	驱动方式 Driven system	控制系统 Control system
AC220V±10V 50/60HZ	0.2	5kgf/cm² 0.49Mpa	8kgf/cm² 0.8Mpa	气动Pneumatic cylinder	YB-X1

综合参数/General Specifications

机型 Model	适用成型机 (ton) Reomended LMM	侧入行程 (mm) Side-entry stroke	上下行程 (mm) Vertical stroke	旋出角度 (度) Swing angle (degree)	夹具旋转角度 (度) Gripper rotate (degree)	最大荷重 (kg) Max. loading	取出时间 (sec) Dry take out time	全循环时间 (sec) Dry cycle time	空气消耗量 (Nl/cycle) Airr consumption	净重(kg) Net weight
YBP650RT	20-150	650	125	选购R:旋转60-90度 无记号不旋转	选购T:爪转180度 无记号不旋转	2	0.9	4.4	5.2	26

外形尺寸/Outer Dimensions

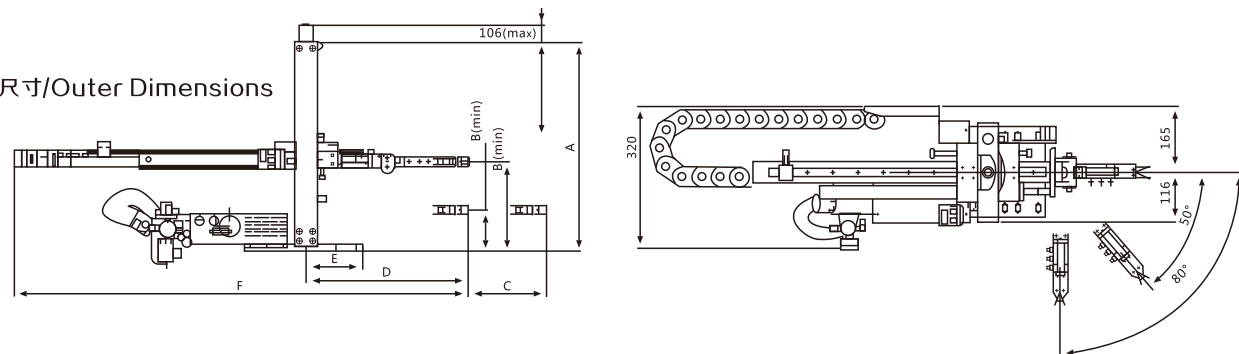

机型 Model	A	B(min)	B(max)	C	D	E	F
YBP650RT	605(685)	105(185)	405(485)	560	295(335)	135	1030(1270)

斜臂机械手

Swing-arm Robots

- 适用锁模力
Clamping force
50~400T
- 手臂型式
Armtype
单截/双截
- 线性轨道
Linearguide
上下线性滑轨
引拔线性导杆
- 周期时间
Cycle time
4.2~6sec
- 控制器
Controller
YB-X1
- 荷重
Load
3KG



外形尺寸/Outer Dimensions

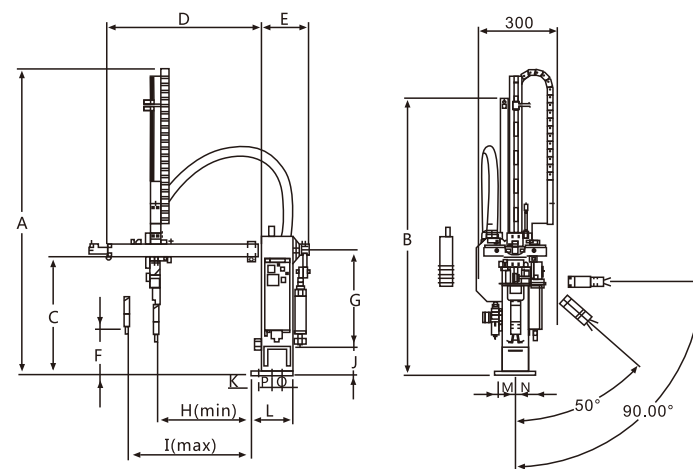

基本参数/Common Specifications

电源 Power source	电源容量 (KVA) Power source	工作气压 Working pressure	最大容许气压 Max, allowed pressure	驱动方式 Driven system	控制系统 Control system
AC220V±10V 50/60HZ	0.2	5kgf/cm² 0.49Mpa	8kgf/cm² 0.8Mpa	气动Pneumatic cylinder	YB-X1

综合参数/General Specifications

机型 Model	适用成型机 (ton) Reomended LMM	上下行程 (mm) Vertical stroke	引拔行程 (mm) Crosswise stroke	旋出角度 (度) Swing angle (degree)	取出时间 (sec) Dry take out time	最大荷重 (kg) Max. loading	空气消耗量 (Nl/cycle) Airr consumption	全循环时间 (sec) Dry cycle time	净重(kg) Net weight
YBP650V/WV	180T以下	650	125	60-90	0.8	3	3-4	4.2/4.4	38/48
YBP850WV	200-400	850	200		1.2				

机型表示: W: 双截式 D: 成品臂+料头臂 V: 全功能(含真空产生器和标准吸置具)
Model denoted: W: Telescopic type D: Product arm+Runner arm V: Total functional type lwith vacuum generator and vacuum jip)

机型Model	A	B	C	D	E	F	G	H	I	J	K	L	M	N	O	P
YBP650V/WV	1320 1110	1220 1090	530	560	250	200	420	50	420	120	15	175	75	75	30	50
YBP850WV	1210	1190				180		130								

高速模内贴标系统

High-speed in-mold labeling system

► 更高速/Higher Speed

最快时间只需3.2秒内即可完成。
The fastest time can be completed in 3.2 seconds.

► 更环保/More environmentally friendly

一体成型效果永久，极具环保材质，令薄壁产品的附加值进一步提高。

The integral molding effect is permanent, and the material is extremely environmentally friendly, which further improves the added value of thin-walled products.



► 基本参数/Common Specifications

机型 Model	适用注塑机 (ton) Apple IMM	进入模内行程 (mm) Into the mold stroke	模内行程 (mm) Mold stroke	上下行程 (mm) Vertical stroke	最大荷重 (kg) Max.loading	取出时间 (sec) Dry take out time	全循环时间 (sec) Dry cycle time	净重(kg) Net weight
YBM12	290T	1200	400	650	13		3.2	8

► 外形尺寸/Outer Dimensions

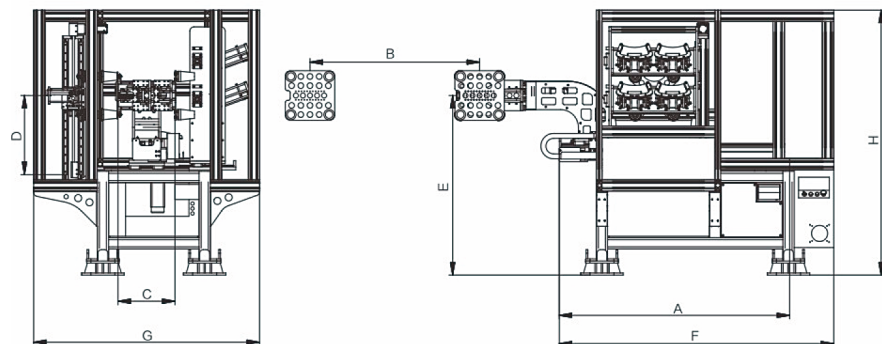

机型 Model	A	B	C	D	E	F	G	H
YBM12	1630	1200	400	650	1270	1950	1600	1887

高速侧取机械手

High-speed side take manipulator

► 侧入式机械手的设计方法将保护机器在高速运行时的磨损。更长的使用寿命，有效地解决了工厂高度不足以使用传统机械手的问题。

The design method of the side-entry manipulator will protect the machine at high speedTime wear. Longer service life, effectively solve the factoryThe problem of insufficient height to use traditional manipulators.



► 基本参数/Common Specifications

机型 Model	适用注塑机 (ton) Apple IMM	进入模内行程 (mm) Into the mold stroke	模内行程 (mm) Mold stroke	上下行程 (mm) Vertical stroke	最大荷重 (kg) Max.loading	取出时间 (sec) Dry take out time	全循环时间 (sec) Dry cycle time	净重(kg) Net weight
YBM09	380T	850	560	460	12		5	6.5

► 外形尺寸/Outer Dimensions

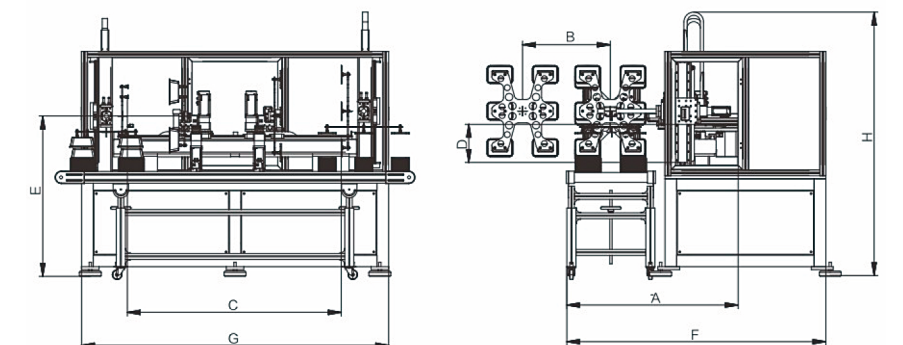

机型 Model	A	B	C	D	E	F	G	H
YBM09	1171	850	1456	460	1095	1771	2100	1799

数控车床机械手

CNC lathe manipulator

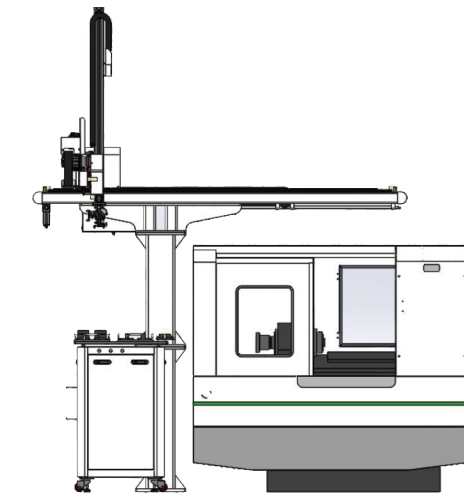

主视图
Main view

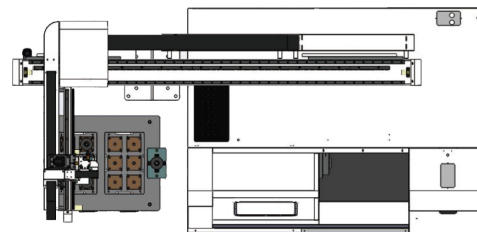

俯视图
Top view

基本参数/Common Specifications

机型 Model	YBC3	YBC5	YBC8	
夹取工件重量 Gripping workpiece weight	<=3kg	<=5kg	<=8kg	
重复定位精度 Repeatability	±0.05mm	±0.08mm	±0.1mm	
Z轴 Z axis	Max行程 Max stroke	5.5m	5m	5m
	Max线性速度 Max linear speed	1.5m/s	1.2m/s	1.0m/s
	驱动方式 Driving method	高精度伺服 High-precision servo		
	电机功率 Motor Power	400W	750W	1000W/1500W
Y轴 Y axis	Max行程 Max stroke	1.5m	1.5m	1.5m
	Max线性速度 Max linear speed	1.2m/s	1.0m/s	0.8m/s
	驱动方式 Driving method	高精度伺服 High-precision servo		
电机功率 Motor Power	400W	750W	1000W	
电气控制系统 Electric control system	专业工业控制系统 Professional industrial control system			
操控系统 Control System	触控彩屏 Touch screen			
料仓 Silo	根据产品工艺要求及尺寸量身定制 (点阵/皮带/旋转等) Tailored according to product process requirements and dimensions (Lattice/belt/rotation, etc.)			
安全防护与报警 Safety protection and alarm	根据产品工艺要求及尺寸量身定制 Tailored according to product process requirements and dimensions			
在线检测 Online test	根据客户要求增加视觉/电子赛规等在线检测 Accordin to customer requirements to increase visual / electronic rules and other online testing			

伺服轴数可加选：最高支持6轴

The number of servo axes can be added: support up to 6 axes

数控车床机械手

CNC lathe manipulator

外形尺寸/Outer Dimensions

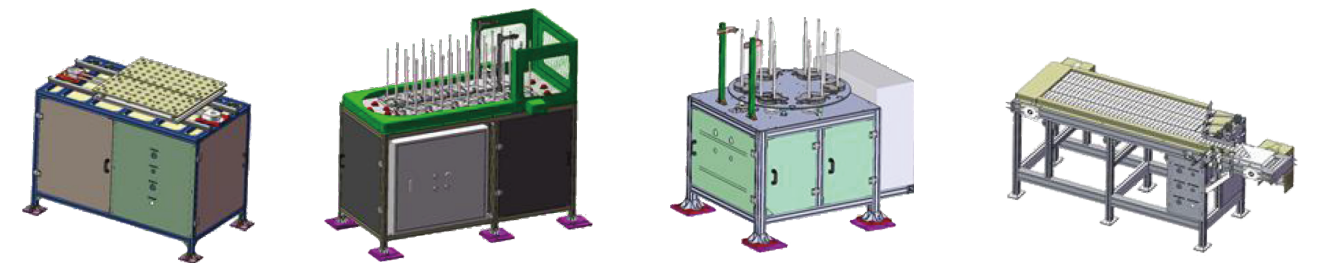
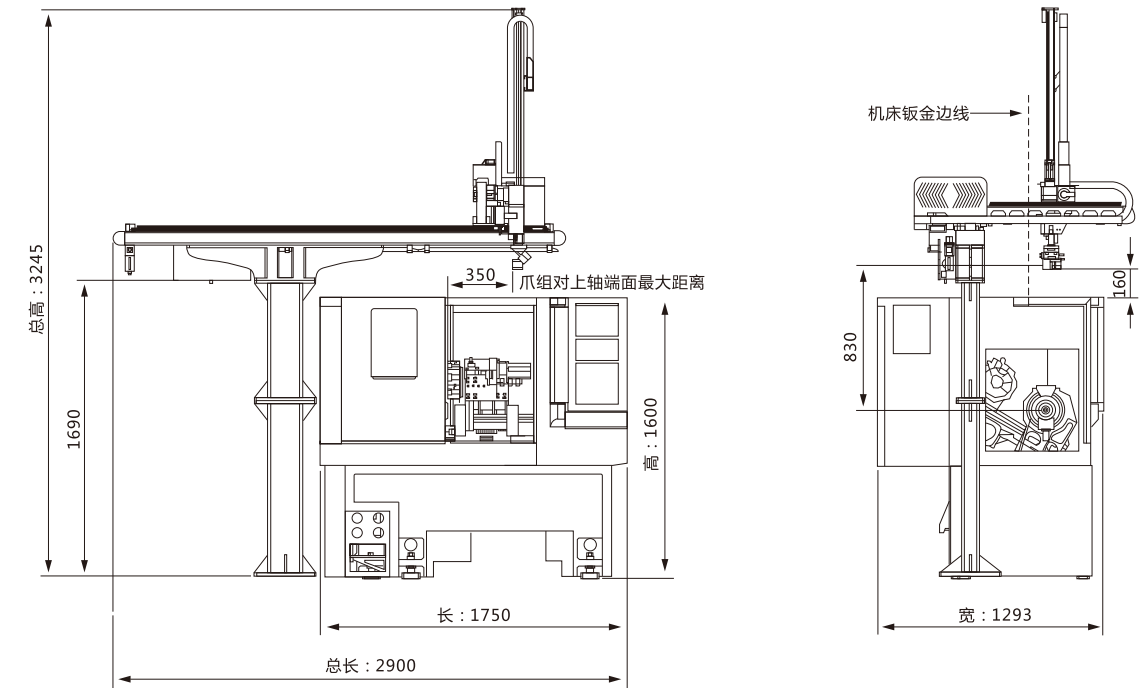

点阵式料仓
适用工作：
通过工件形状特征进行
自定位的任何形式工件
Dot Matrix Silo
Applicable work:
any form of workpiece that can
be self-positioned by the shape
feature

环形旋转料仓
适用工作：盘类、法兰类、环形工件等

Circular rotating silo
Applicable work:
discs, flanges, ring workpieces, etc.

圆形旋转料仓
适用工作：盘类、法兰类、环形工件等

Circular rotating silo
Applicable work:
discs, flanges, ring workpieces, etc.

板链式料仓
适用工作：盘类、法兰类、环形工件等

Plate chain silo
Applicable work:
discs, flanges, ring workpieces, etc.

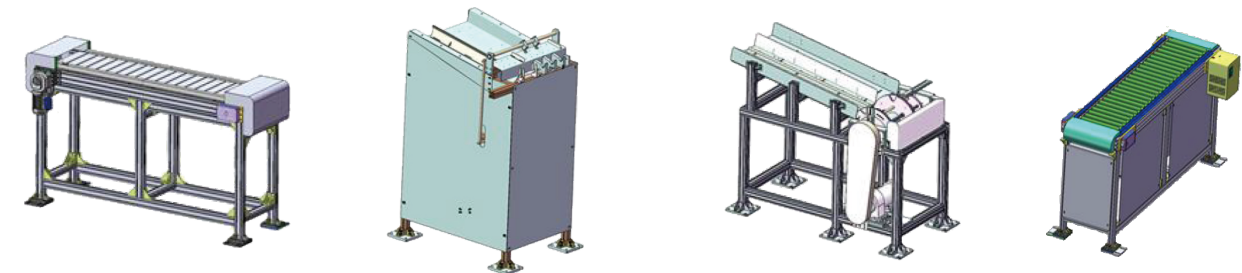

链条料仓
适用工作：轴类工件
Chain silo
Applicable work:
shaft workpiece

顶升式料仓
适用工作：棒类、管类工件
Jack-up silo
Applicable work:
rod and tube workpieces

拔盘式料仓
适用工作：轴类、阶梯轴类工件
Pull-tray silo
Applicable work:
shaft, stepped shaft workpiece

皮带料仓
适用工作：轴类工件
Belt silo
Applicable work:
shaft workpiece

四轴水平机器人

Selective Compliance Assembly Robot Arm

YBR06S4K5



基本参数/Common Specifications

结构形式 Structure type	水平关节式机器人 Horizontal articulated robot	
自由度 Degree of freedom	4	
有效负载 Payload	5KG	
最大活动半径 Maximum radius of activity	600mm	
重复定位精度 Repeatability	±0.02mm	
运动范围 Range of motion	X轴 X axis	±140°
	Y轴 Y axis	±144°
	Z轴 Z axis	0-150mm
	R轴 R axis	±360°
	本体实际重量 Actual weight	31KG
环境条件 Environmental conditions	温度 Temperature	0~45°C
	湿度 Humidity	20~80%RH (不结露No condensation)
	振动 Vibration	4.9m/s ² 以下The following
	◊不可有引火性及腐蚀性气体、液体 ◊不可涉及水、油、粉 ◊不可靠近电磁气源 ◊No flammable and corrosive gas, liquid ◊Do not involve water, oil, powder ◊Do not approach the source of electromagnetic gas	
电源容量 Battery capacity	0.95KVA	

外形尺寸/Outer Dimensions

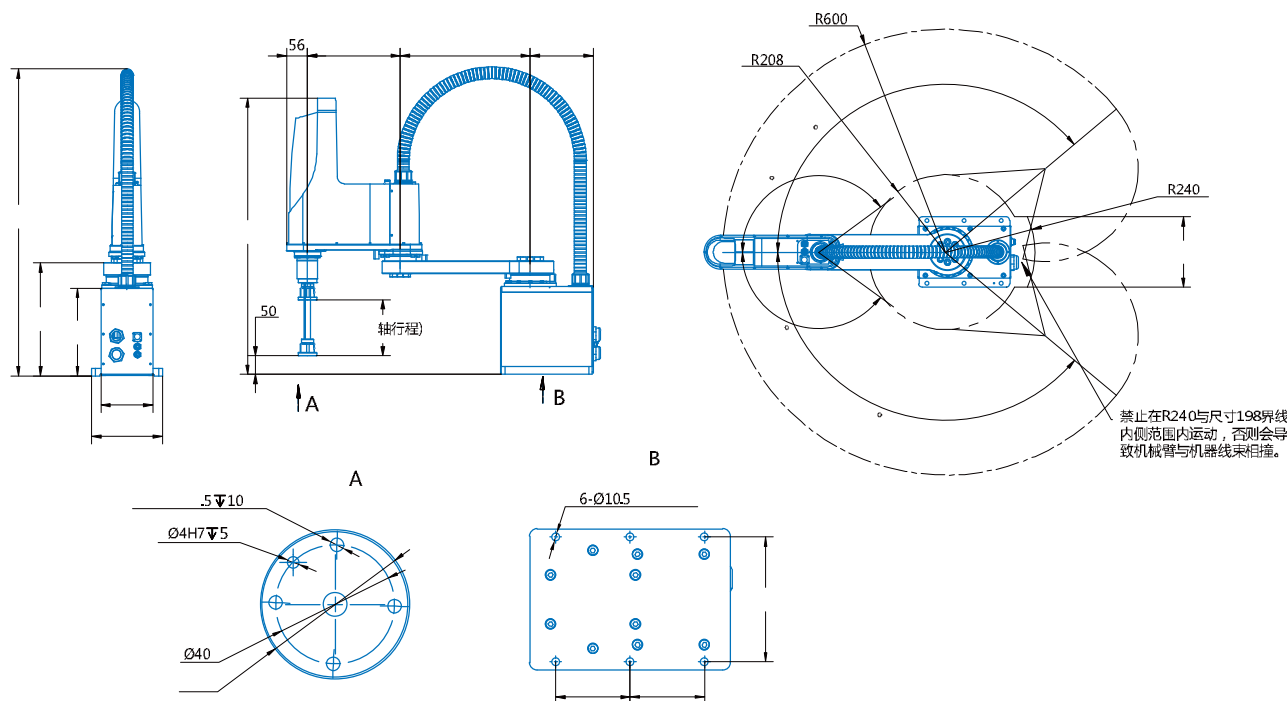

六自由度工业机器人

Six Axis Industrial Robot

YBR08S6K7



基本参数/Common Specifications

结构形式 Structure type	水平关节式机器人 Horizontal articulated robot	
自由度 Degree of freedom	6	
有效负载 Payload	7KG	
最大活动半径 Maximum radius of activity	740mm	
重复定位精度 Repeatability	±0.05mm	
运动角度 Movement angle	S轴 S axis	±170°
	L轴 L axis	+130°, -98°
	U轴 U axis	+78°, -145°
	R轴 R axis	±170°
	B轴 B axis	±130°
	T轴 T axis	±360°
本体实际重量 Actual weight	43KG	
环境条件 Environmental conditions	温度 Temperature	0~45°C
	湿度 Humidity	20~80%RH (不结露No condensation)
	振动 Vibration	4.9m/s ² 以下The following
	◊不可有引火性及腐蚀性气体、液体 ◊不可涉及水、油、粉 ◊不可靠近电磁气源 ◊No flammable and corrosive gas, liquid ◊Do not involve water, oil, powder ◊Do not approach the source of electromagnetic gas	
电源容量 Battery capacity	3.0KVA	

外形尺寸/Outer Dimensions

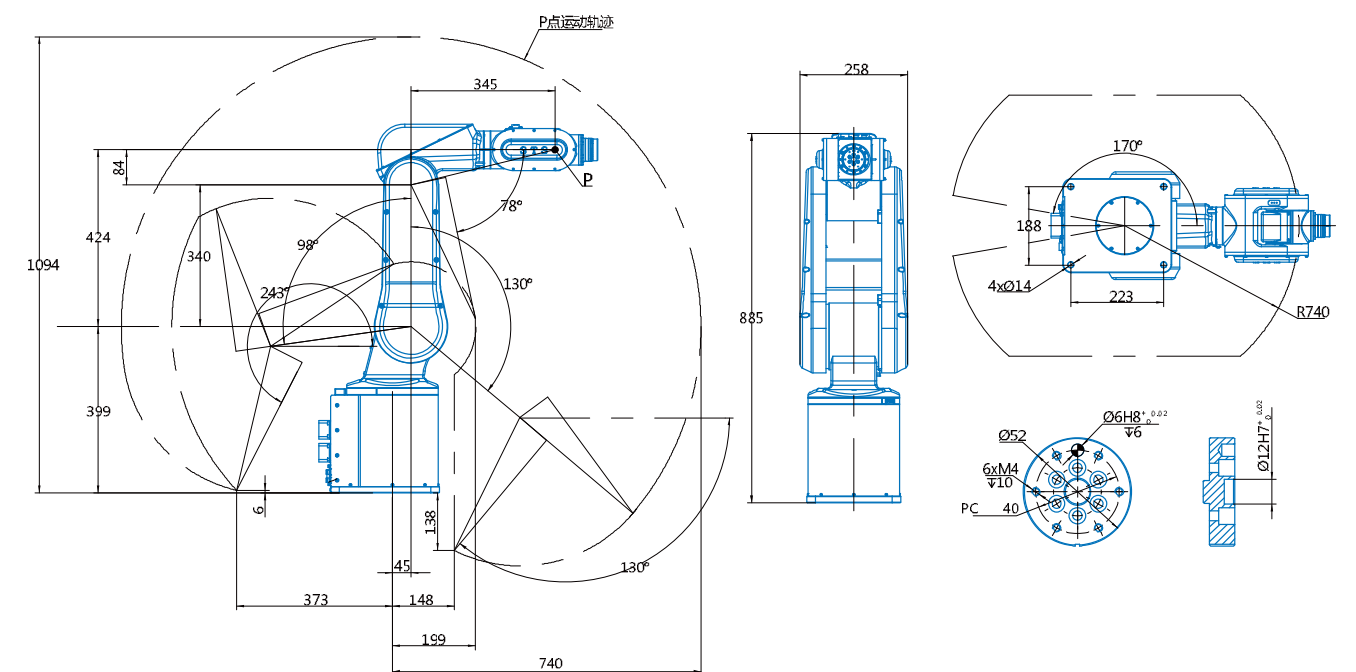

六自由度工业机器人

Six Axis Industrial Robot

YBR15S6K10

产品特点/Product Features

- ◊轻、中型负载水平，适用范围广；
- ◊标配16个路IO口，支持IO板的快速扩充；
- ◊内置6路IO线材，有效解决工作中的线材缠绕问题；
- ◊提供多种安装方式：地面、倾斜、悬挂。
- ◊Light and medium load level, wide application range;
- ◊Standard 16 IO ports, support rapid expansion of IO board;
- ◊Built-in 6-way IO wire, effectively solve the wire winding problem in the working process;
- ◊Provide a variety of installation methods: ground, tilt, suspension.

主要应用/Main Applications

- 搬运 Transport
- 上下料 Loading and unloading
- 焊接 welding
- 其他 other



六自由度工业机器人

Six Axis Industrial Robot

YBR18S6K20

产品特点/Product Features

- ◊适用于中型负载水平，承载能力更强，臂展范围大，适用范围广；
- ◊标配16个路IO口，支持IO板的快速扩充；
- ◊内置6路IO线材，有效解决工作中的线材缠绕问题；
- ◊提供多种安装方式：地面、倾斜、悬挂。
- ◊Suitable for medium load level, stronger carrying capacity, large arm span, and wide application range;
- ◊Standard 16 IO ports, support rapid expansion of IO board;
- ◊Built-in 6-way IO wire, effectively solve the wire winding problem in the working process;
- ◊Provide a variety of installation methods: ground, tilt, suspension.

主要应用/Main Applications

- 搬运 Transport
- 上下料 Loading and unloading
- 组装 Assembly
- 焊接 welding
- 其他 other

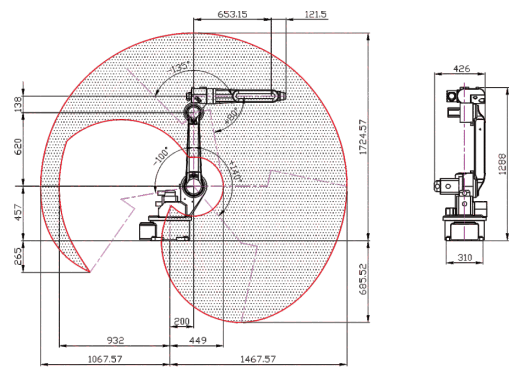

机器人工作空间/Robot workspace

机器人底座尺寸/Robot base size

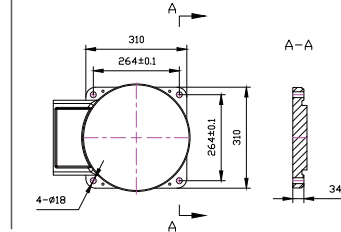

机器人末端法兰尺寸/Robot end flange size

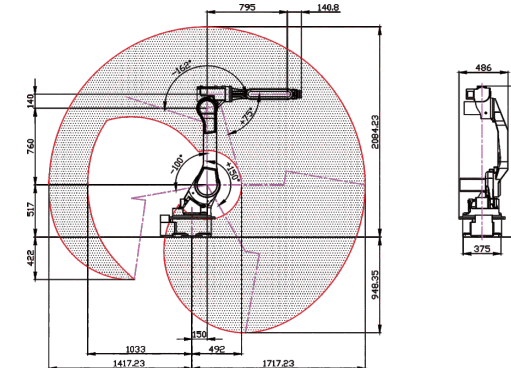
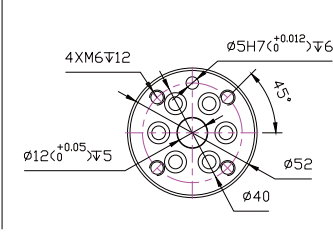

机器人工作空间/Robot workspace

机器人底座尺寸/Robot base size

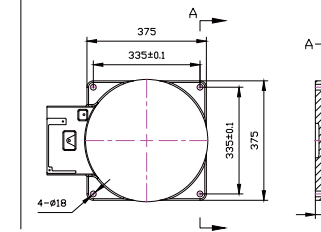

机器人末端法兰尺寸/Robot end flange size

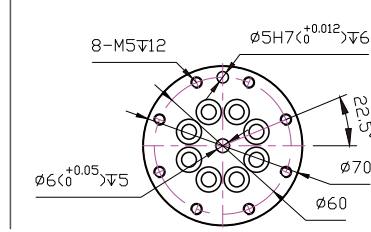

基本参数/Common Specifications

控制轴 No.Control Axes	6	
有效载荷 Payload (kg)	10	
动作区域 (mm) Max.Reach (mm)	1468	
重复定位精度 Pos.rep (mm)	±0.08	
动作范围 (°) Motion Range (°)	J1轴 J1 axis	±170
	J2轴 J2 axis	+140/-100
	J3轴 J3 axis	+80/-135
	J4轴 J4 axis	±170
	J5轴 J5 axis	±130
	J6轴 J6 axis	±360
最高速度* (°/s) Max.Speed* (°/s)	J1轴 J1 axis	190
	J2轴 J2 axis	140
	J3轴 J3 axis	140
	J4轴 J4 axis	220
	J5轴 J5 axis	150
	J6轴 J6 axis	320

各轴电机功率 (kw) Motor Output (kw)	J1轴 J1 axis	1.5
	J2轴 J2 axis	1.5
	J3轴 J3 axis	0.75
	J4轴 J4 axis	0.2
	J5轴 J5 axis	0.2
	J6轴 J6 axis	0.2
重量 (kg) Weight (kw)	约161	
安装条件 Installation	地面、悬挂、倾斜 Ground, suspension, tilt	
防护等级 Levels of protection	IP54	
运行条件 Ambient temperature /Humidity/ Vibration	环境温度：0~40°C 环境湿度：通常在75% RH以下（无结霜现象） 短期90%RH以下（1个月之内） 振动加速度：4.9m/s2(0.5G)以下 Ambient temperature: 0~40°C Environmental humidity: usually 75% Below RH (no frosting) Short-term below 90% RH (within 1 month) Vibration acceleration: 4.9m/s2 (0.5G) or less	

基本参数/Common Specifications

控制轴 No.Control Axes	6	
有效载荷 Payload (kg)	20	
动作区域 (mm) Max.Reach (mm)	1717	
重复定位精度 Pos.rep (mm)	±0.08	
动作范围 (°) Motion Range (°)	J1轴 J1 axis	±170
	J2轴 J2 axis	+150/-100
	J3轴 J3 axis	+75/-162
	J4轴 J4 axis	±170
	J5轴 J5 axis	±130
	J6轴 J6 axis	±360
最高速度* (°/s) Max.Speed* (°/s)	J1轴 J1 axis	148
	J2轴 J2 axis	110
	J3轴 J3 axis	140
	J4轴 J4 axis	200
	J5轴 J5 axis	170
	J6轴 J6 axis	320

各轴电机功率 (kw) Motor Output (kw)	J1轴 J1 axis	1.5
	J2轴 J2 axis	2
	J3轴 J3 axis	1.5
	J4轴 J4 axis	0.4
	J5轴 J5 axis	0.2
	J6轴 J6 axis	0.2
重量 (kg) Weight (kw)	约161	
安装条件 Installation	地面、悬挂、倾斜 Ground, suspension, tilt	
防护等级 Levels of protection	IP54	
运行条件 Ambient temperature /Humidity/ Vibration	环境温度：0~40°C 环境湿度：通常在75% RH以下（无结霜现象） 短期90%RH以下（1个月之内） 振动加速度：4.9m/s2(0.5G)以下 Ambient temperature: 0~40°C Environmental humidity: usually 75% Below RH (no frosting) Short-term below 90% RH (within 1 month) Vibration acceleration: 4.9m/s2 (0.5G) or less	

四轴冲压工业机器人

Four-axis Stamping Robot

YBR15S4K12



基本参数/Common Specifications

结构形式 Structure type	立式多关节机器人 Vertical multi-joint robot	
自由度 Degree of freedom	4	
有效负载 Payload	12KG	
最大活动半径 Maximum radius of activity	1454mm	
重复定位精度 Repeatability	±0.15mm	
运动范围 Range of motion	S轴 S axis	±140°
	L轴 L axis	-35°+80°
	U轴 U axis	-95°+35°
	T轴 T axis	±360°
本体重量 Body weight	159.5KG	
环境条件 Environmental conditions	温度 Temperature	0~45°C
	湿度 Humidity	20~80%RH (不结露No condensation)
	振动 Vibration	4.9m/s ² 以下The following
	◊不可有引火性及腐蚀性气体、液体 ◊不可涉及水、油、粉 ◊不可靠近电磁气源头 ◊No flammable and corrosive gas, liquid ◊Do not involve water, oil, powder ◊Do not approach the source of electromagnetic gas	
电源容量 Battery capacity	4.64KVA	

外形尺寸/Outer Dimensions

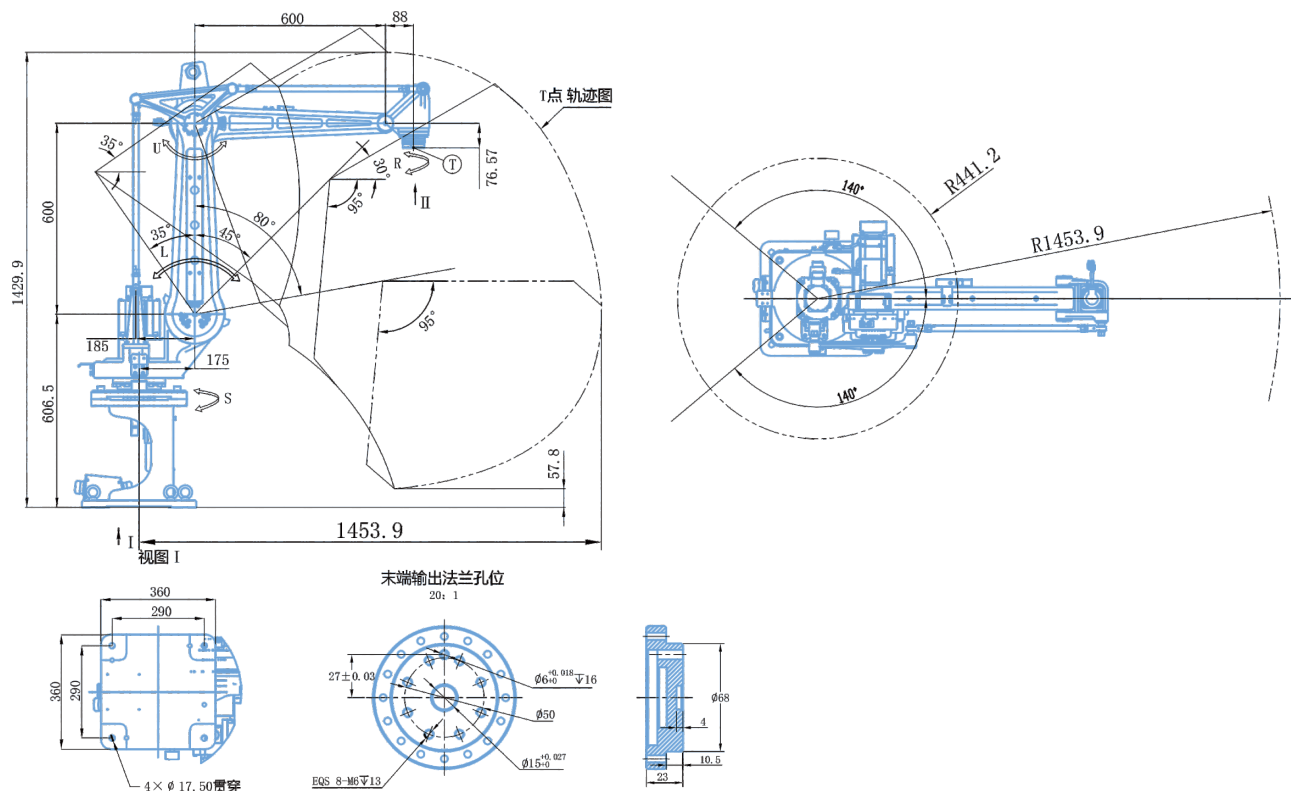

四轴冲压工业机器人

Four-axis Stamping Robot

YBR18S4K25



基本参数/Common Specifications

结构形式 Structure type	立式多关节机器人 Vertical multi-joint robot	
自由度 Degree of freedom	4	
有效负载 Payload	25KG	
最大活动半径 Maximum radius of activity	1800mm	
重复定位精度 Repeatability	±0.15mm	
运动范围 Range of motion	S轴 S axis	±160°
	L轴 L axis	-25°, +90°
	U轴 U axis	-68°, +15°
	T轴 T axis	±360°
本体重量 Body weight	241KG	
环境条件 Environmental conditions	温度 Temperature	0~45°C
	湿度 Humidity	20~80%RH (不结露No condensation)
	振动 Vibration	4.9m/s ² 以下The following
	◊不可有引火性及腐蚀性气体、液体 ◊不可涉及水、油、粉 ◊不可靠近电磁气源头 ◊No flammable and corrosive gas, liquid ◊Do not involve water, oil, powder ◊Do not approach the source of electromagnetic gas	
电源容量 Battery capacity	7.5KVA	

外形尺寸/Outer Dimensions

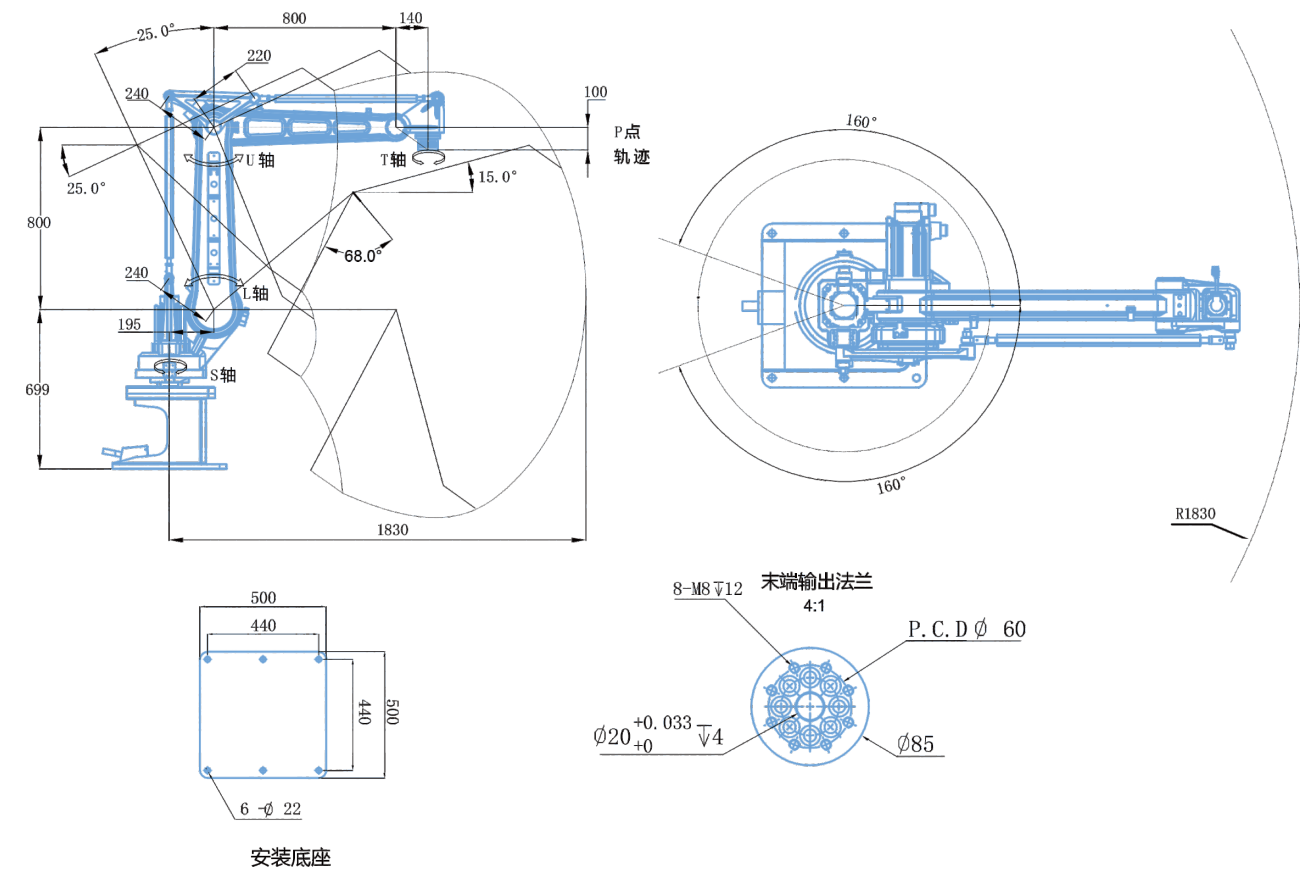

四轴冲压工业机器人

Four-axis Stamping Robot

YBR16S4K4



基本参数/Common Specifications

结构形式 Structure type	水平多关节机器人 Horizontal articulated robot	
自由度 Degree of freedom	4	
有效负载 Payload	5KG	
最大活动半径 Maximum radius of activity	1600mm	
重复定位精度 Repeatability	±0.15mm	
运动范围 Range of motion	S轴 S axis	±135°
	Z轴 Z axis	420mm
	X轴 X axis	1100-1600mm
	T轴 T axis	±180°
本体重量 Body weight	220KG	
环境条件 Environmental conditions	温度 Temperature	0~45°C
	湿度 Humidity	20~80%RH (不结露No condensation)
	振动 Vibration	4.9m/s ² 以下The following
	◊不可有引火性及腐蚀性气体、液体 ◊不可涉及水、油、粉 ◊不可靠近电磁气源头 ◊No flammable and corrosive gas, liquid ◊Do not involve water, oil, powder ◊Do not approach the source of electromagnetic gas	
电源容量 Battery capacity	2.0KVA	

外形尺寸/Outer Dimensions

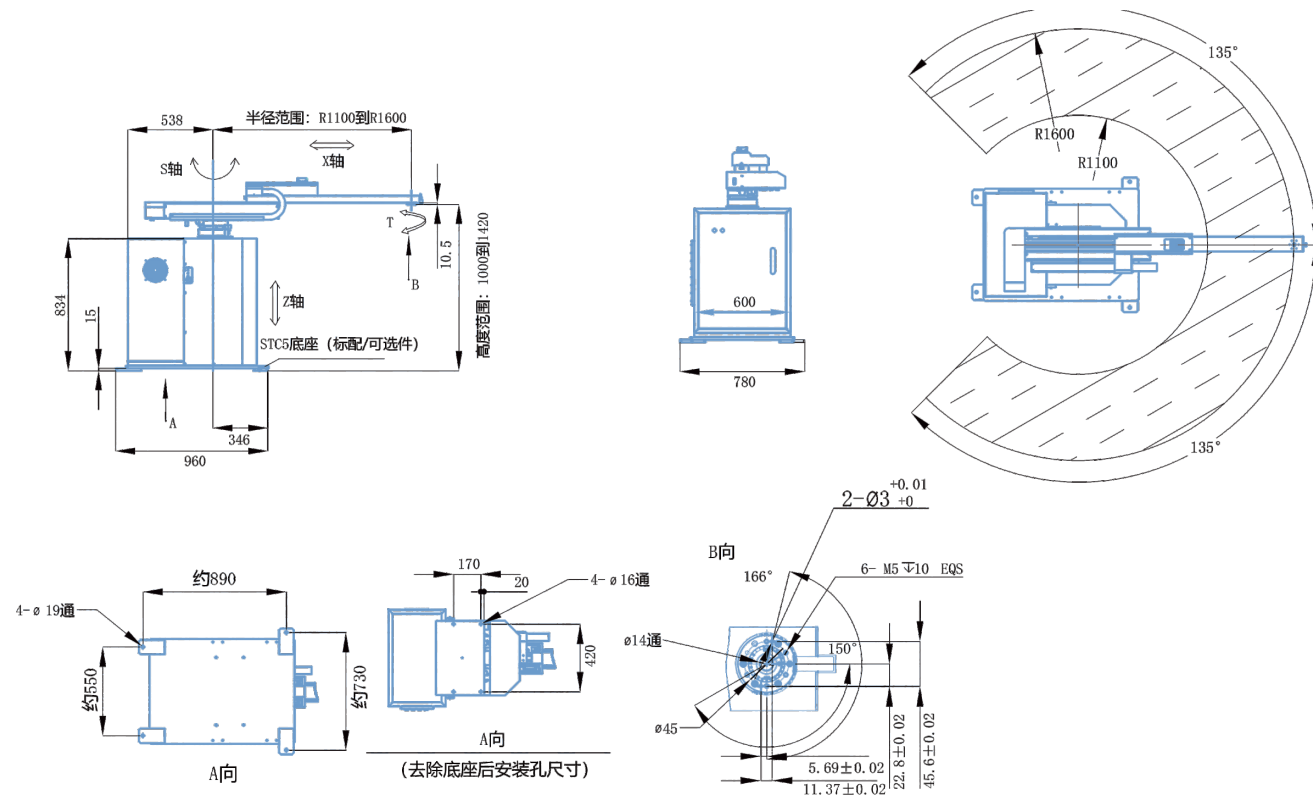

四轴冲压工业机器人

Four-axis Stamping Robot

YBR17S4K20

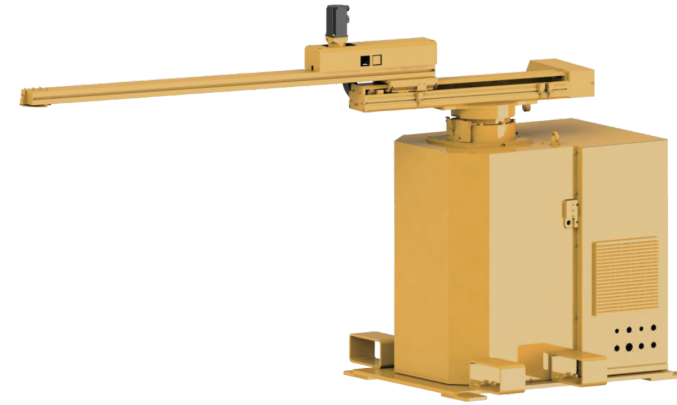

基本参数/Common Specifications

结构形式 Structure type	水平关节式机器人 Horizontal articulated robot	
自由度 Degree of freedom	4	
有效负载 Payload	20KG	
最大活动半径 Maximum radius of activity	1700mm	
重复定位精度 Repeatability	±0.15mm	
运动范围 Range of motion	S轴 S axis	±135°
	Z轴 Z axis	420mm
	X轴 X axis	1100-1700mm
	T轴 T axis	±180°
本体重量 Body weight	300KG	
环境条件 Environmental conditions	温度 Temperature	0~45°C
	湿度 Humidity	20~80%RH (不结露No condensation)
	振动 Vibration	3.5KVA
	◊不可有引火性及腐蚀性气体、液体 ◊不可涉及水、油、粉 ◊不可靠近电磁气源头 ◊No flammable and corrosive gas, liquid ◊Do not involve water, oil, powder ◊Do not approach the source of electromagnetic gas	
电源容量 Battery capacity	0.95KVA	

外形尺寸/Outer Dimensions

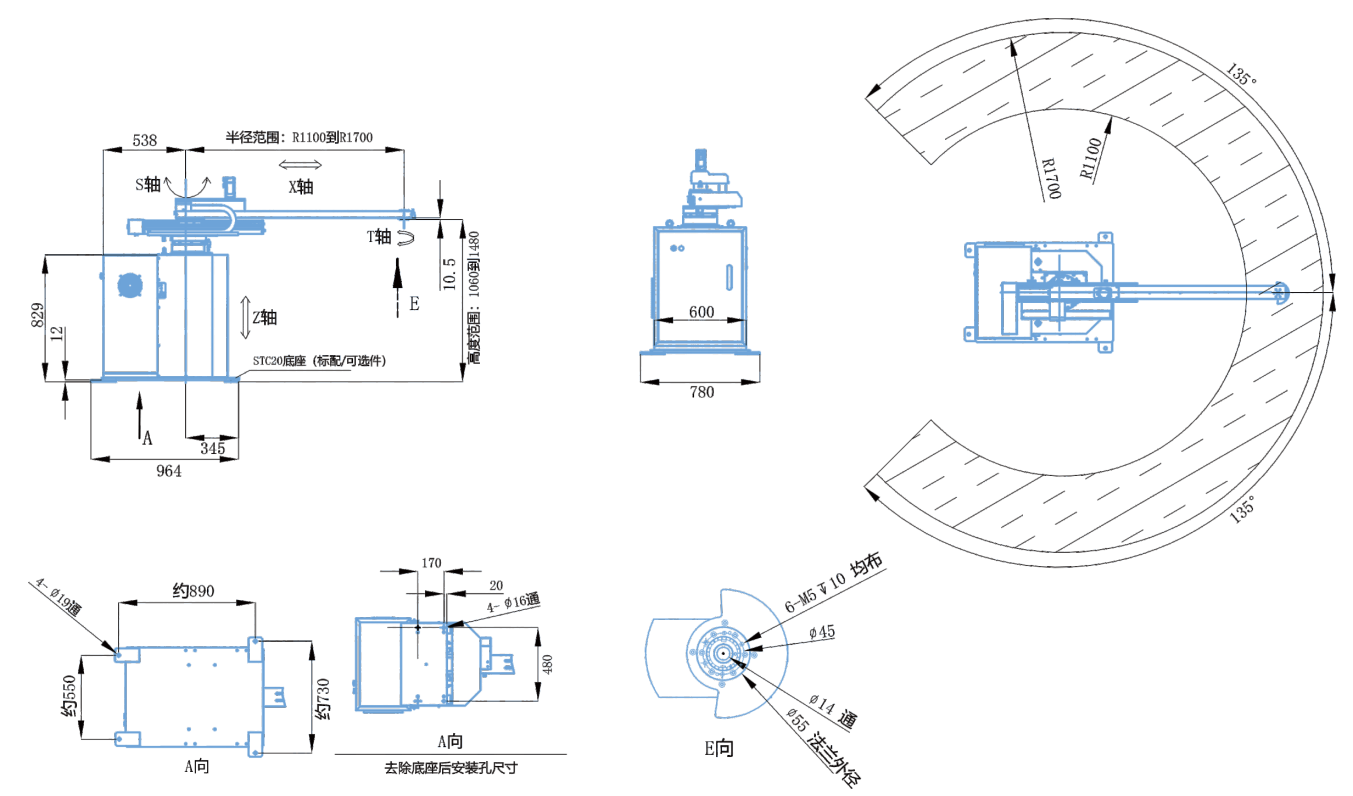

并联式工业机器人

Parallel industrial robot

YBY08S3(S4)K3



基本参数/Common Specifications

自由度数 Degrees of freedom	3轴/4轴 3 axis/4 axis			
额定负载 (KG) Specified load (KG)	3KG			
工作行程范围 Working stroke range	上臂长 Upper arm length	300		
	下臂长 Lower arm length	800		
	L	1103		
	M	163		
	N	132		
	A	858		
	B	813		
	C	295		
	D	206		
重复定位精度 Repeatability	±0.1mm			
驱动电机类型 Drive motor type	绝对值伺服电机 Absolute servo motor			
不同负载 (KG) Different load (KG)	0.5	1.5	2	3
节拍S (25/300/25) Beat S (25/300/25)	0.30	0.45	0.56	0.65
总功率/电压 Total power/voltage	2.25KW(轴)2.3KW(4轴)220V单机 2.25KW (axis) 2.3KW (4 axes) 220V single machine			
整机重量 Total Weight	55KG			
防护等级 Protection level	IP54			

尺寸/Size

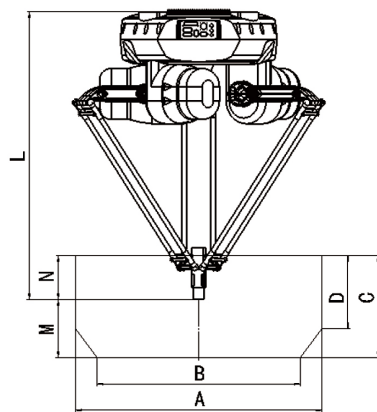

行程尺寸/Stroke size

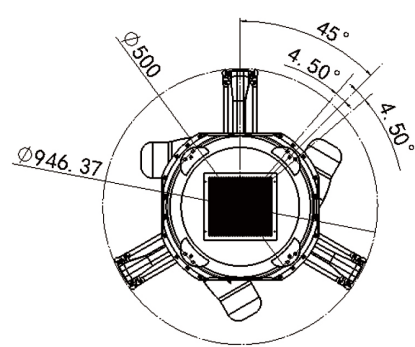

安装尺寸/Installation size

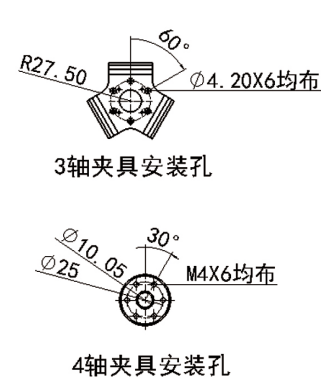

夹具尺寸/Fixture size

并联式工业机器人

Parallel industrial robot

YBY09S3(S4)K4



基本参数/Common Specifications

自由度数 Degrees of freedom	3轴/4轴 3 axis/4 axis			
额定负载 (KG) Specified load (KG)	4KG			
工作行程范围 Working stroke range	上臂长 Upper arm length	400		
	下臂长 Lower arm length	900		
	L	1124		
	M	207		
	N	168		
	A	1260		
	B	1008		
	C	375		
	D	262		
重复定位精度 Repeatability	±0.1mm			
驱动电机类型 Drive motor type	绝对值伺服电机 Absolute servo motor			
不同负载 (KG) Different load (KG)	0.8	1.6	2.8	3.5
节拍S (25/300/25) Beat S (25/300/25)	0.35	0.40	0.55	0.65
总功率/电压 Total power/voltage	2.25KW(轴)2.3KW(4轴)220V单机 2.25KW (axis) 2.3KW (4 axes) 220V single machine			
整机重量 Total Weight	65KG			
防护等级 Protection level	IP54			

尺寸/Size

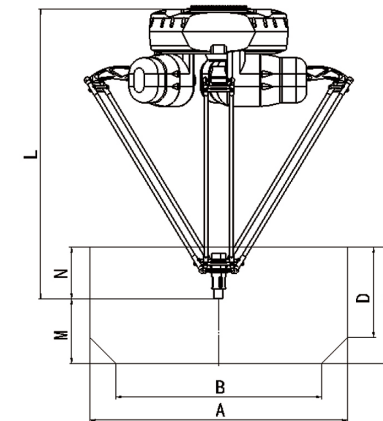

行程尺寸/Stroke size

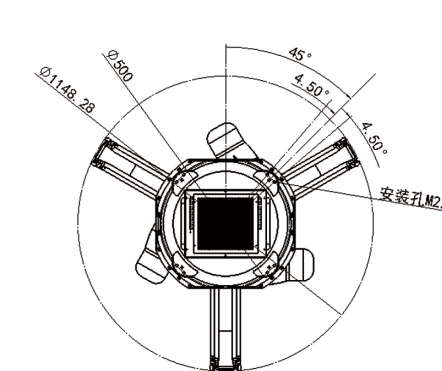

安装尺寸/Installation size

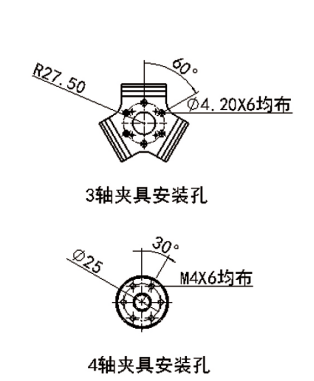

夹具尺寸/Fixture size

轻型协作工业机器人

Lightweight collaborative industrial robot

YBQR08S6K5

关节采用EtherCAT通讯
Joints use EtherCAT communication



基本参数/Common Specifications

结构形式 Structure type	立式多关节机器人 Vertical multi-joint robot	
自由度 Degree of freedom	6	
有效负载 Payload	5KG	
最大活动半径 Maximum radius of activity	717.5mm	
重复定位精度 Repeatability	±0.05mm	
运动角度 Movement angle	S轴 S axis	±180°
	L轴 L axis	±180°
	U轴 U axis	±180°
	R轴 R axis	±180°
	B轴 B axis	±180°
	T轴 T axis	±360°
本体重量 Body weight	20KG	
环境条件 Environmental conditions	温度 Temperature	0~45°C
	湿度 Humidity	20~80%RH (不结露No condensation)
	振动 Vibration	4.9m/s ² 以下The following
	◊不可有引火性及腐蚀性气体、液体 ◊不可涉及水、油、粉 ◊不可靠近电磁气源头 ◊No flammable and corrosive gas, liquid ◊Do not involve water, oil, powder ◊Do not approach the source of electromagnetic gas	
电源容量 Battery capacity	0.25KVA	

尺寸/Size

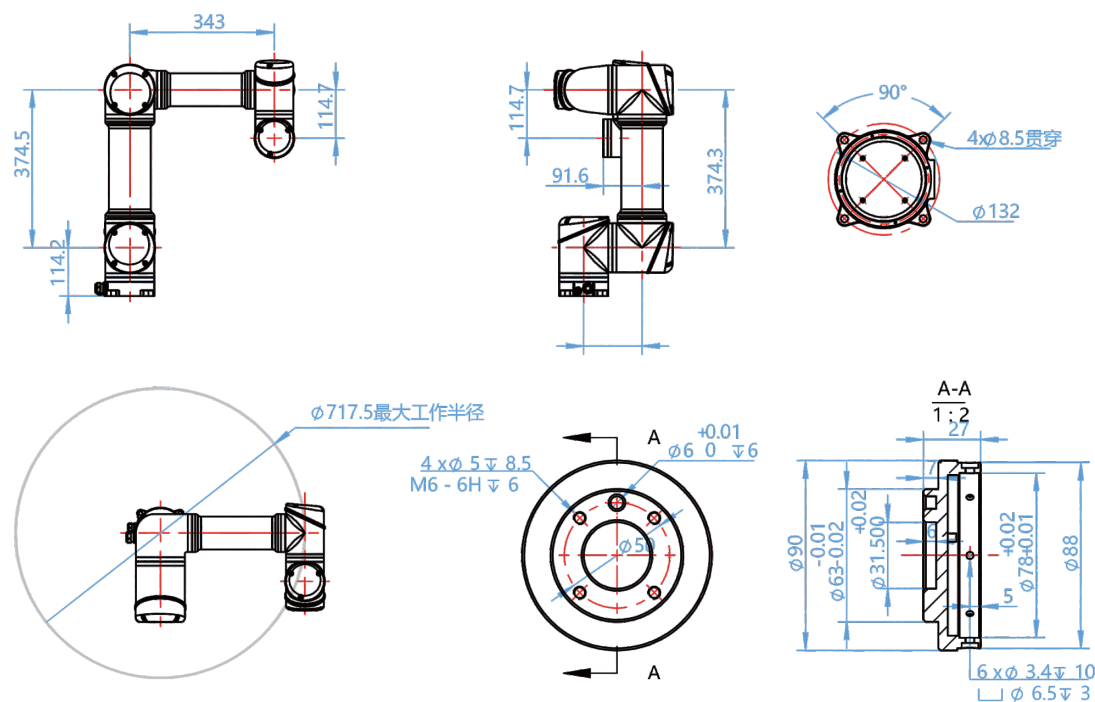

轻型协作工业机器人

Lightweight collaborative industrial robot

YBQR12S6K10

关节采用EtherCAT通讯
Joints use EtherCAT communication



基本参数/Common Specifications

结构形式 Structure type	立式多关节机器人 Vertical multi-joint robot	
自由度 Degree of freedom	6	
有效负载 Payload	10KG	
最大活动半径 Maximum radius of activity	1183.7mm	
重复定位精度 Repeatability	±0.05mm	
运动角度 Movement angle	S轴 S axis	±180°
	L轴 L axis	±180°
	U轴 U axis	±180°
	R轴 R axis	±180°
	B轴 B axis	±180°
	T轴 T axis	±360°
本体重量 Body weight	30KG	
环境条件 Environmental conditions	温度 Temperature	0~45°C
	湿度 Humidity	20~80%RH (不结露No condensation)
	振动 Vibration	4.9m/s ² 以下The following
	◊不可有引火性及腐蚀性气体、液体 ◊不可涉及水、油、粉 ◊不可靠近电磁气源头 ◊No flammable and corrosive gas, liquid ◊Do not involve water, oil, powder ◊Do not approach the source of electromagnetic gas	
电源容量 Battery capacity	0.35KVA	

尺寸/Size

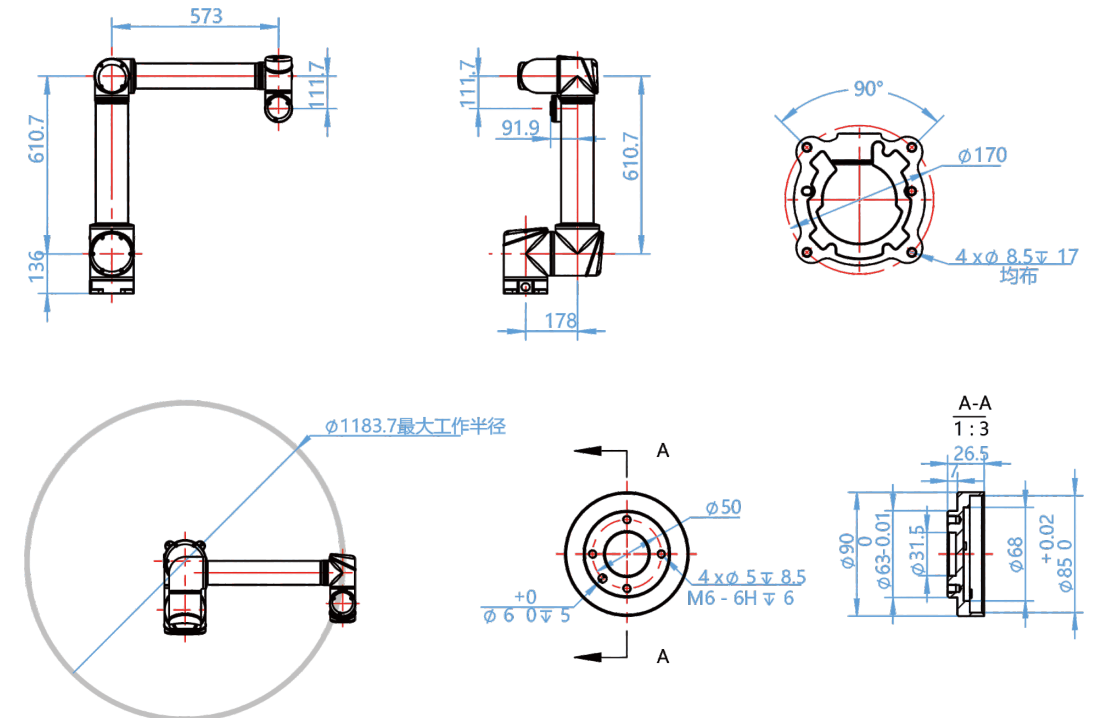

输送带

Conveyor



- ◇全机框体采用高强度合金铝挤型材制作，经久耐用不变形。
- ◇两头高度可调节，操作方便，旋转手轮即可。
- ◇附四个带刹脚轮，移动方便，不用手轮可折叠，不占空间。
- ◇皮带运转速度和方向可随时调节切换，反应迅速。
- ◇配备标准接头，与其他设备运接方便。

- ◇The whole machine frame is made of high-strength alloy aluminum extruded profiles, which is durable and does not deform.
- ◇The height of the two ends can be adjusted, and the operation is convenient, just by rotating the hand wheel.
- ◇Four casters with brakes are attached, which are easy to move, and can be folded without hand wheels, which does not take up space.
- ◇The belt speed and direction can be adjusted and switched at any time, and the response speed is fast.
- ◇Equipped with standard connectors, it is convenient to transport and connect with other equipment.

基本参数/Common Specifications

机型Model	YB-02W	YB-03W	YB-04W	YB-05W	YB-06W
皮带宽度 (mm) Width of belt	200	300	400	500	600
输送带长度L (mm) Length of Conveyor	1500/2000/2500/3000/3500/400/4500/5000/5500/6000.....				
低端高度H1(mm) Height of high her end	700-1000				
高端高度H2(mm) Height of high her end	1000-1600				
平面长度L2 (mm) Plane	300(only for TLB-)		500(only for TLB-)		700(only for TLB-)
最大荷重 (kg) Max.Loading	20				
最快速度m/min Max.Speed	12				
皮带 Belt Description	PVC材质/2mm厚/颜色:绿色/耐温:-10℃~80℃/防静电、耐磨、耐油 PVC material/2mm thickness/color: green/temperature resistance: -10℃~80℃/anti-static, wear-resistant, oil-resistant				
电源容量 (KVA) Power Capacity	0.2KVA				
电源 Power Source	单相Simplex AC220V-240V±10V 50/60Hz				

外形尺寸/Outer Dimensions

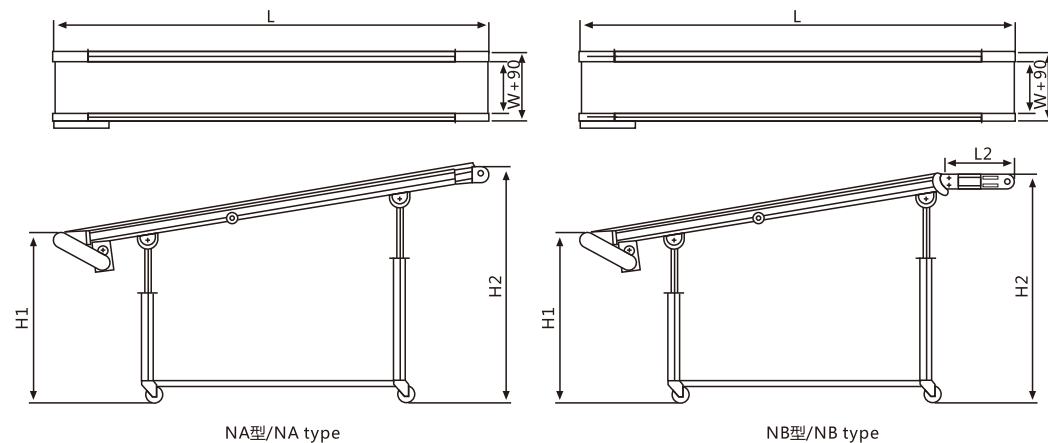

NA型/NA type

NB型/NB type

模内埋入、剪切水口、装箱排列等自动化设备

Non-standard automation equipment

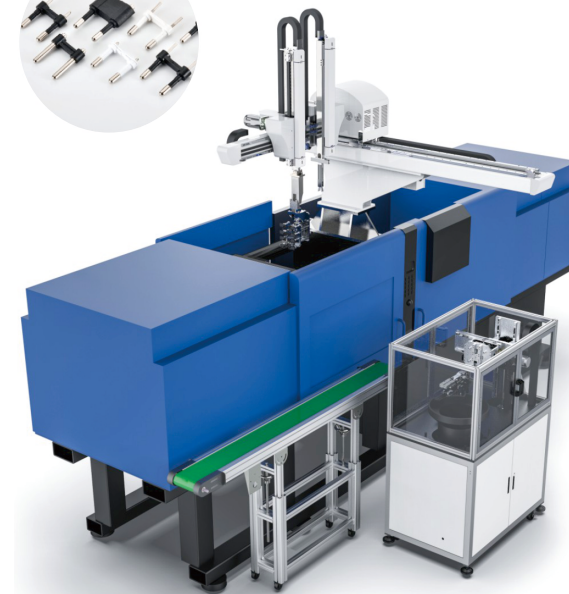

充电器插针埋入注塑
Charger pins are embedded in injection molding



各类螺母埋入注塑
All kinds of nuts are embedded in injection molding

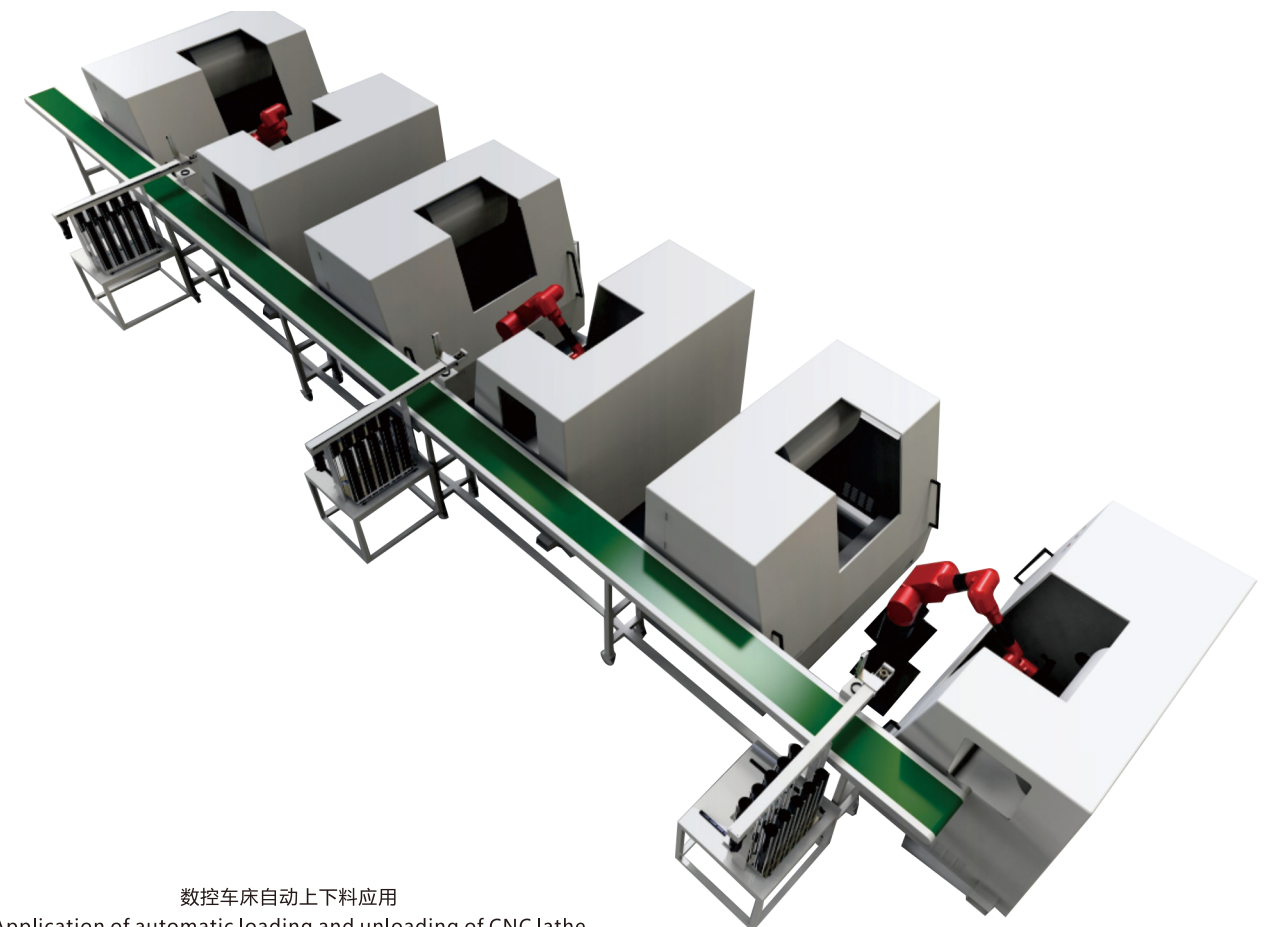

数控车床自动上下料应用
Application of automatic loading and unloading of CNC lathe

客户案例

Customer case



合作伙伴

Partner

SAMPO 新宝
台湾品质 民族品牌

新纶科技
XINLUN TECHNOLOGY

小天鹅
XIAOTIANUE

ZTT 中天科技

大全集团
DAQIANGROUP

东成
Dongcheng

KARCHER
德国凯驰

TSEKAR

THK
The Mark of Linear Motion

Skyworth 创维

GREE 格力
掌握核心科技

新江玻璃
XINJIANG GLASS
好汉

ZHONGMING

Donlim 东菱

VS
威诚国际集团

EMERSON

美的 Midea

OMRON

TCL
创意感动生活
The Creative Life

蓝天特玻
LAN TIAN TE BO

BYD 比亚迪

FUJIFILM

Panasonic

CHNT 正泰

SUNJODA 欣旺达

格力浦电子
CLIP 精密连接器专家

Galanz 格兰仕

F&D 奋达

HKC
深圳惠科股份有限公司

长青集团
CHANT GROUP

力劲集团
L.K. GROUP

YIZUMI 伊之密

樱花锁业

Chant 创尔特

Huayi 华艺卫浴

GULI
ASSA ABLOY

COLORFUL
卡弗照明

FLXT
润星泰

ETI 德豪润达

通宇通讯

UTL 帕德五金压铸有限公司
PAIDE METAL LAMPS CO.,LTD

广东文达镁业科技股份有限公司
Guangdong Wanda Magnesium Technology Co.,Ltd.

longde 龙的

MEITUO 美图